

- ☐ obstoječe
- ☐ tehnološka oprema
- ☐ pohištvo po meri
- ☐ tipsko kovinsko pohištvo

P01
CRK - Knjigoveznica
Guma
58,19 m2

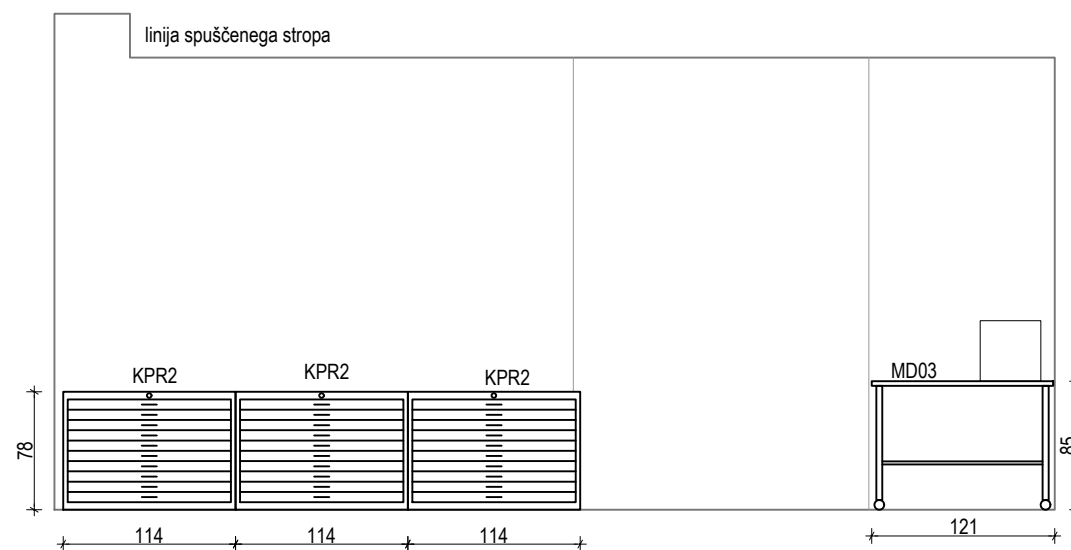
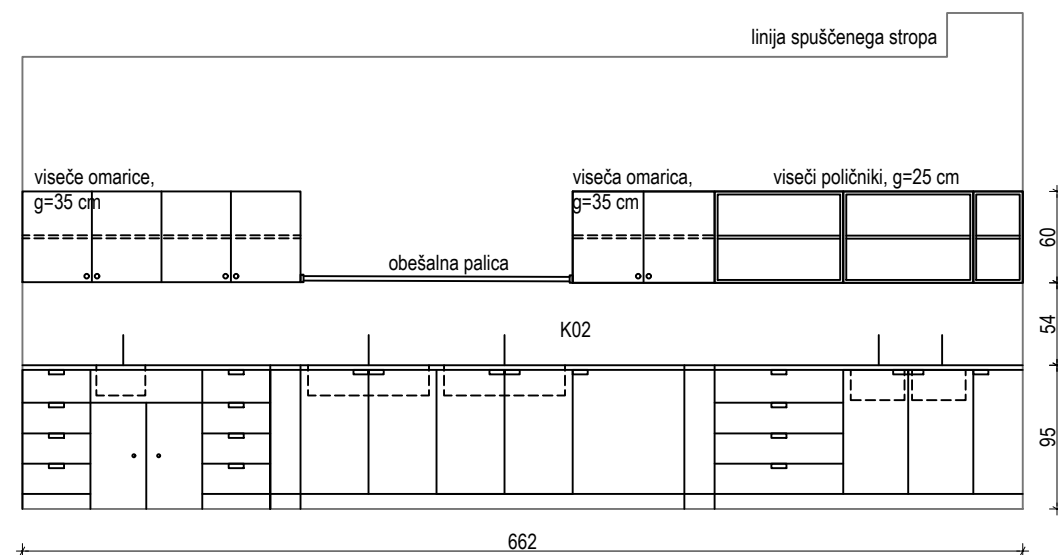
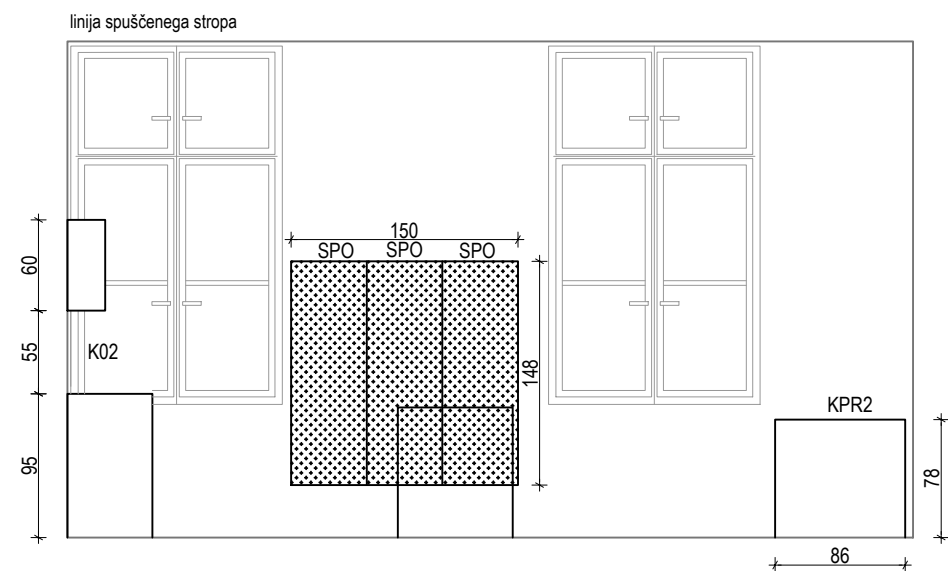
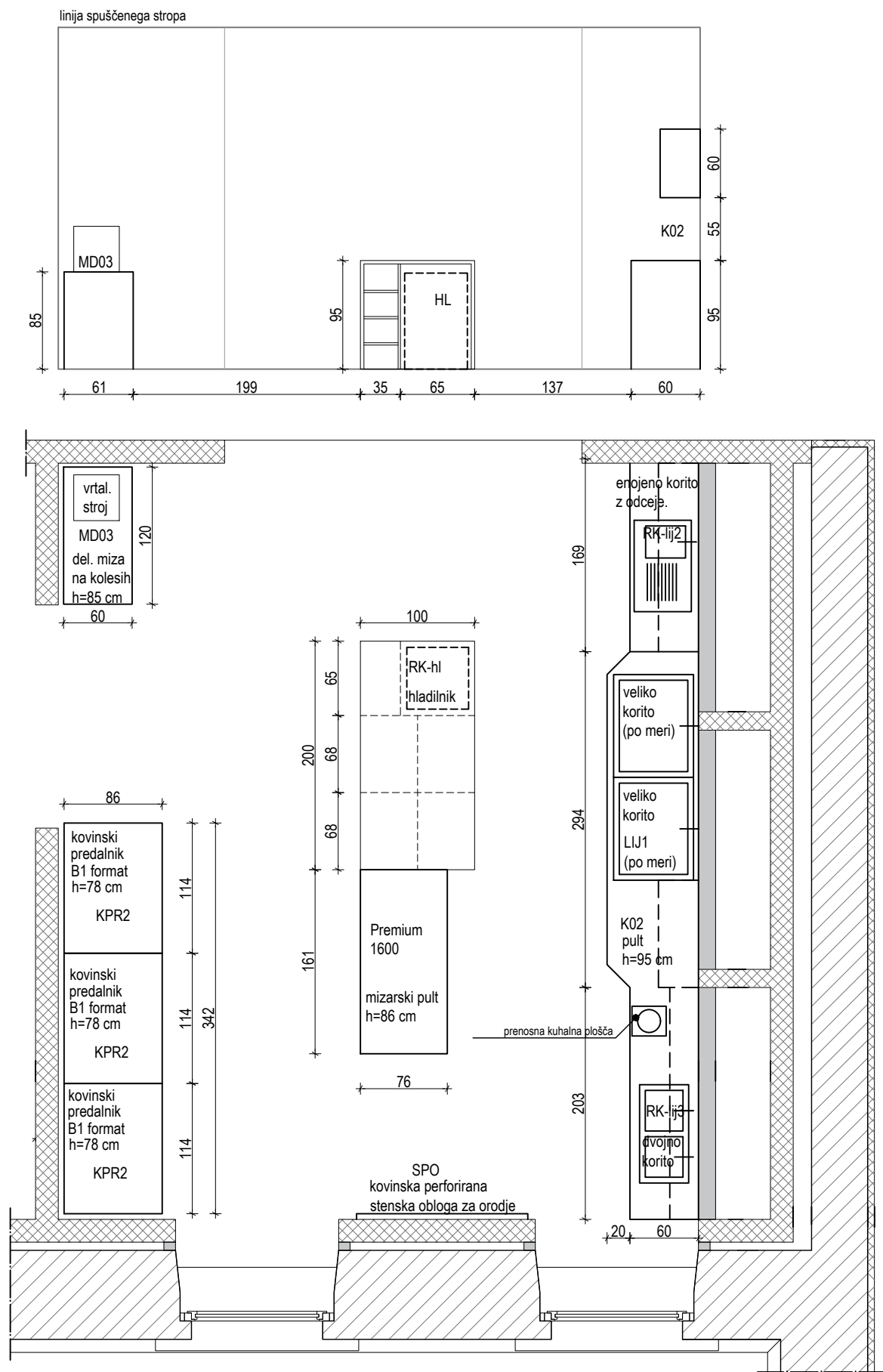

- obstoječe
- tehnološka oprema
- pohištvo po meri
- tipsko kovinsko pohištvo

P02
CRK - Obdelovalnica
- mokra linija
Guma
39,32 m2

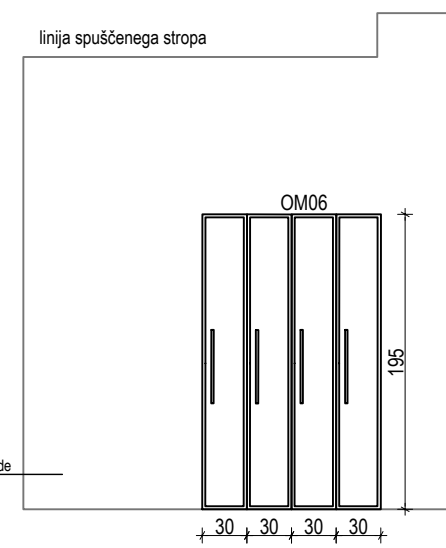
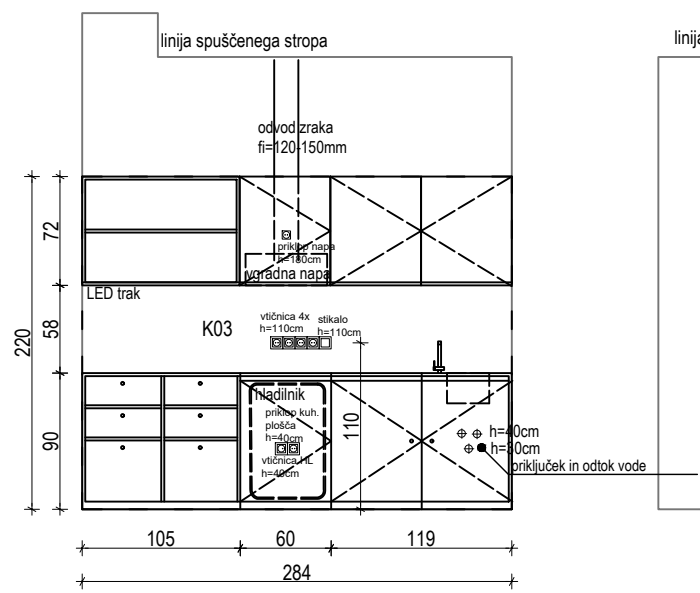
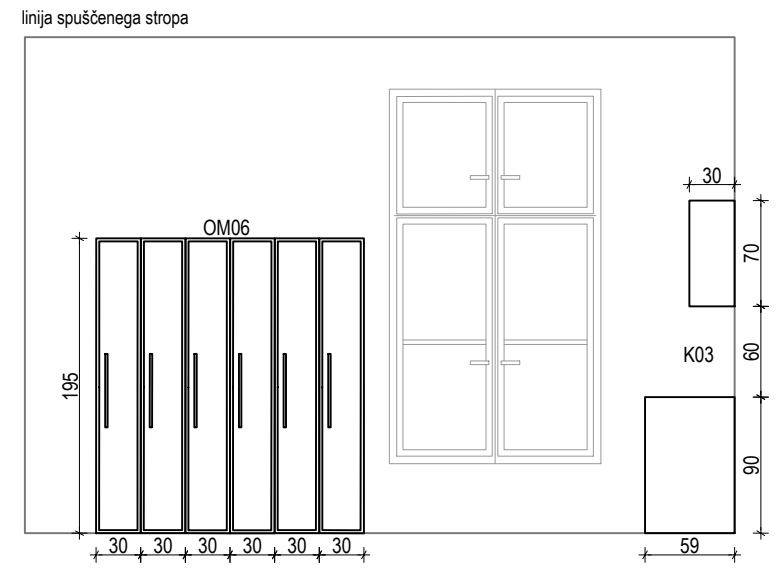
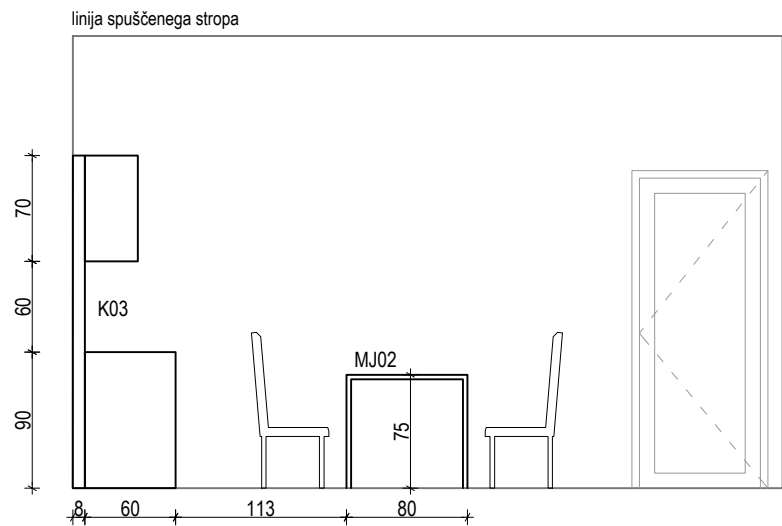
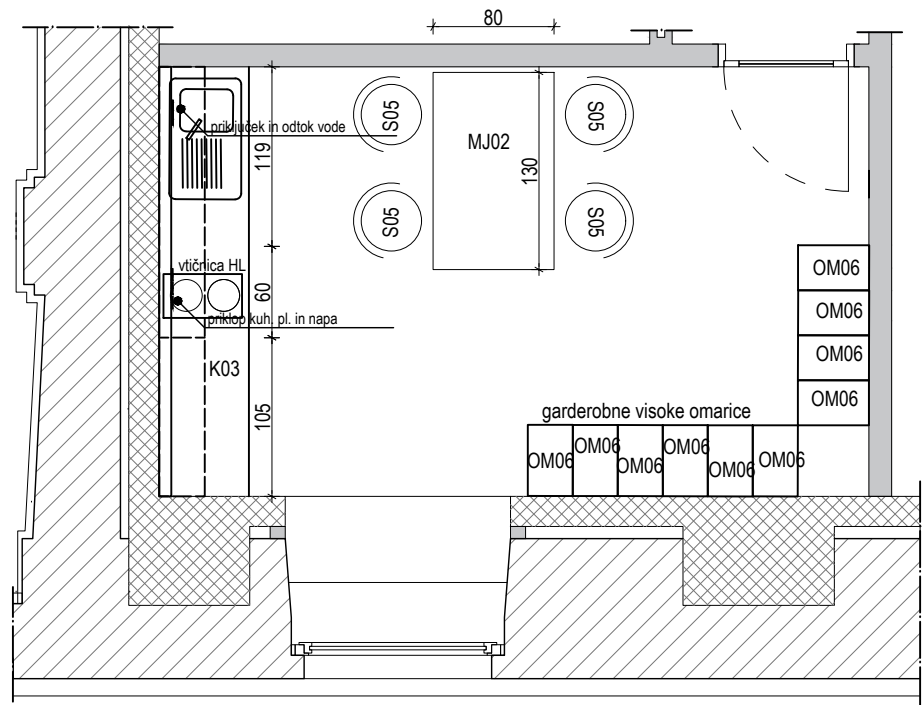

- tehnološka oprema
- pohištvo po meri
- tipski elementi

P06
CRK - Garderoba zap.
Guma
14,19 m2

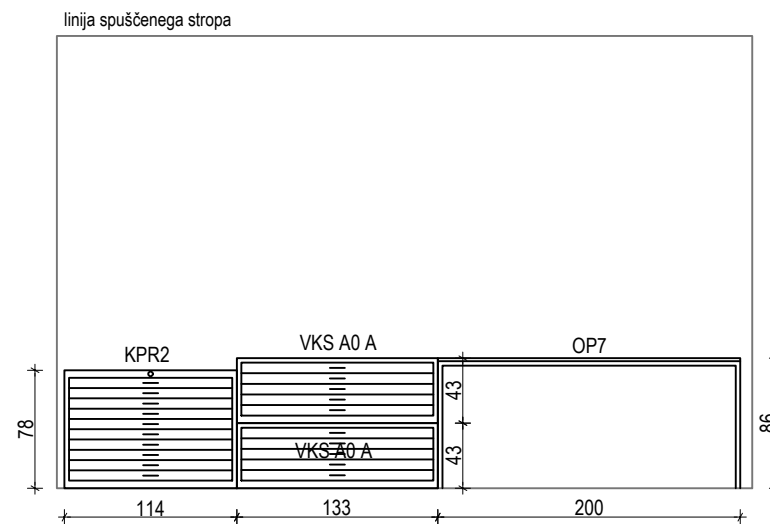
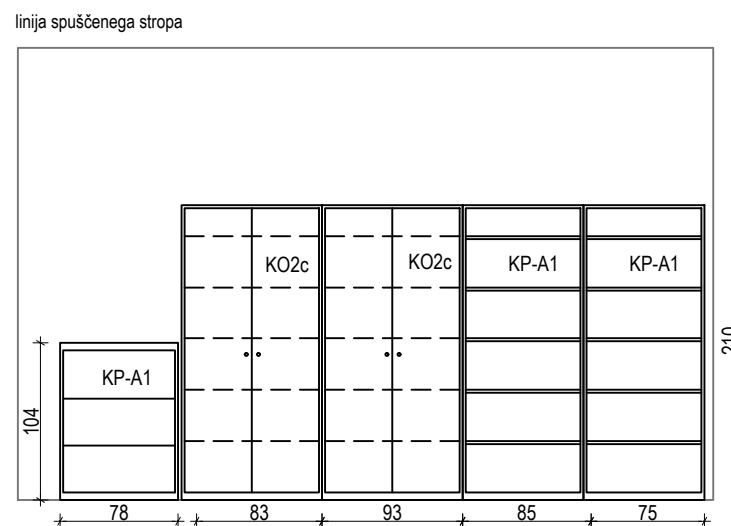
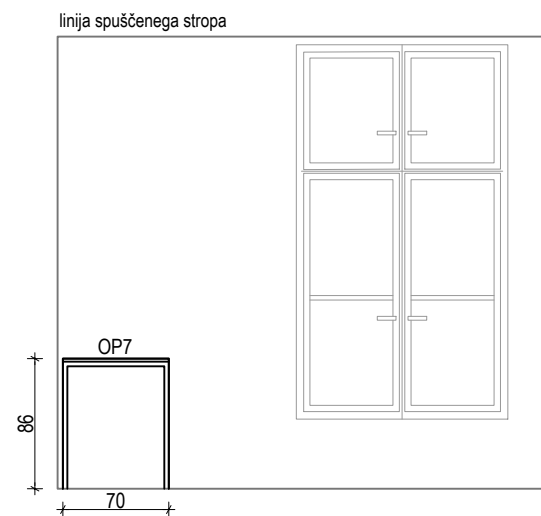
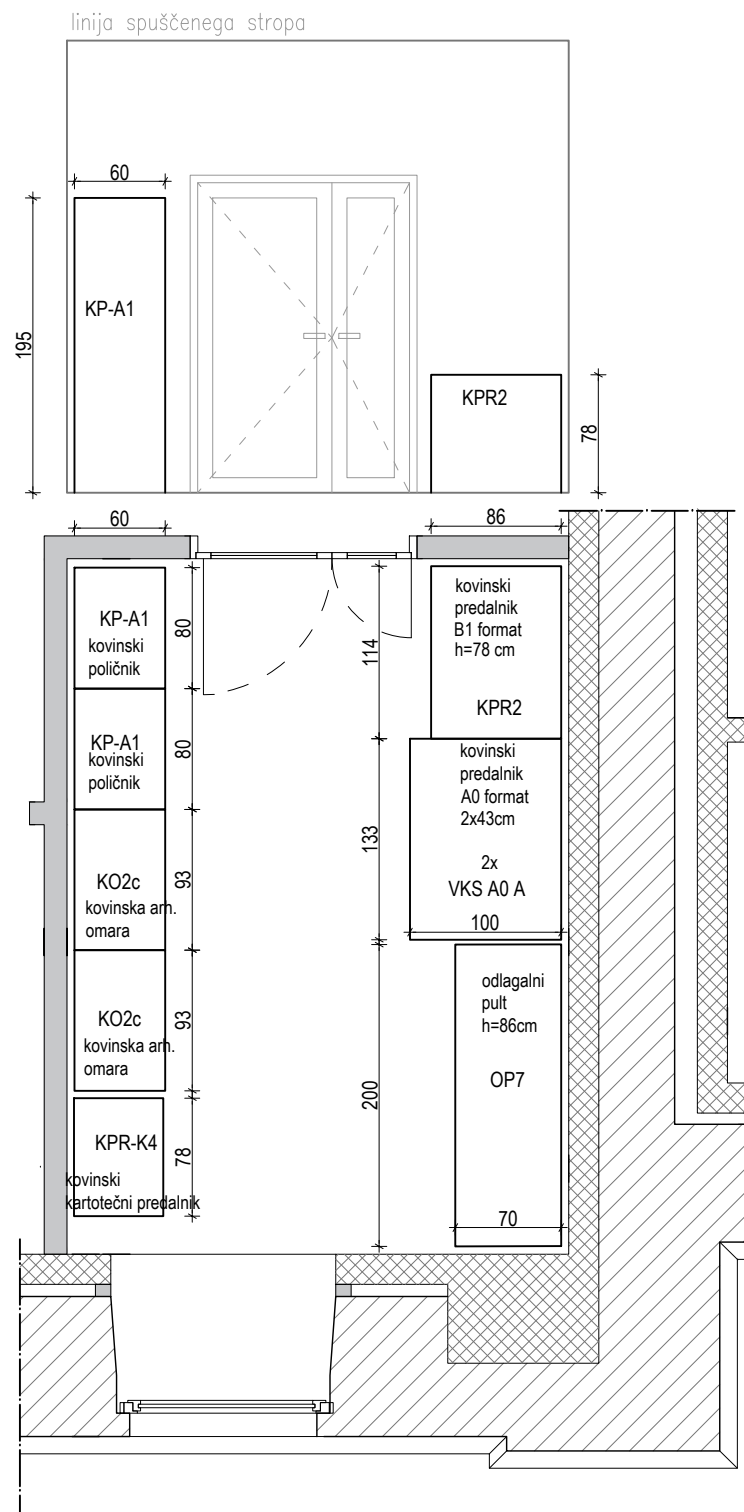

P07
CRK - Sprejemnica
Guma
15,69 m2

- pohištvo po meri
■ tipsko kovinsko pohištvo

linija spuščene stropa

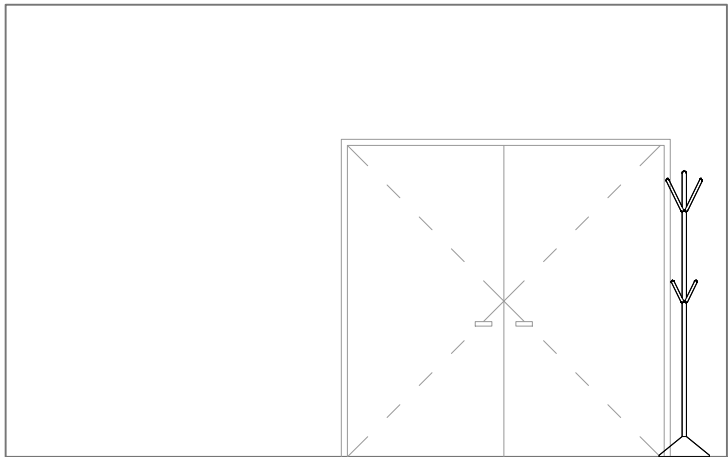

linija spuščene stropa

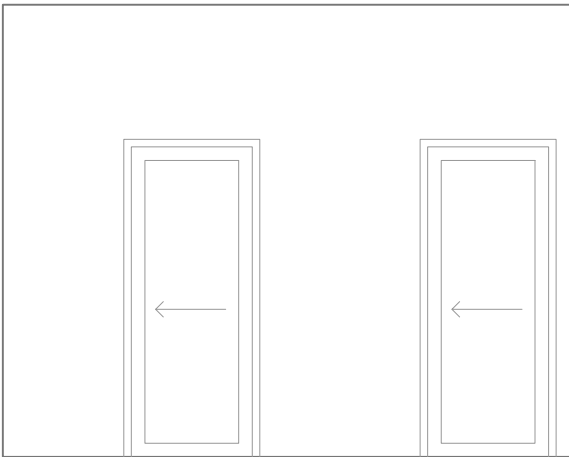

linija spuščene stropa

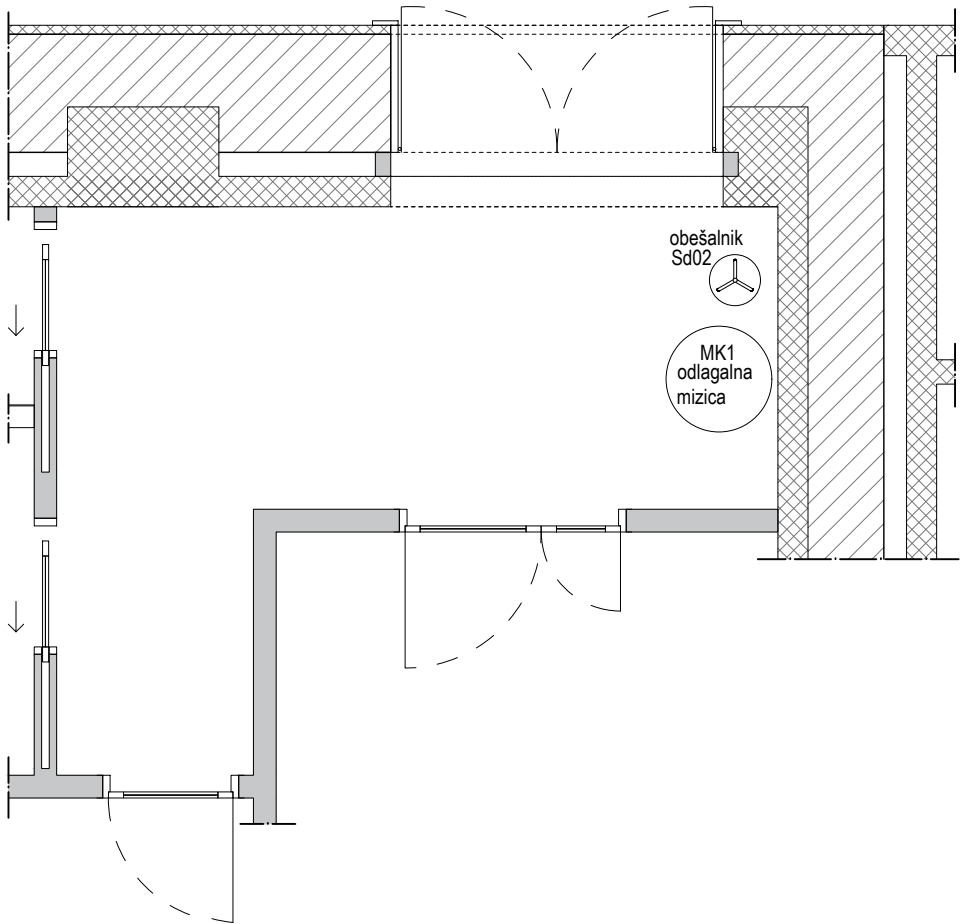
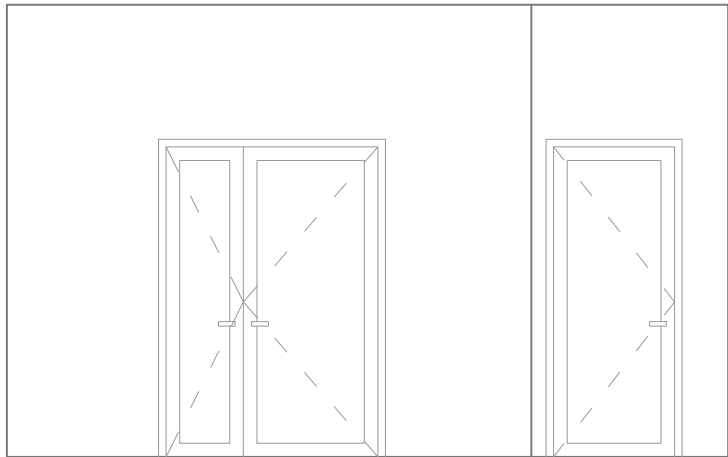

linija spuščene stropa

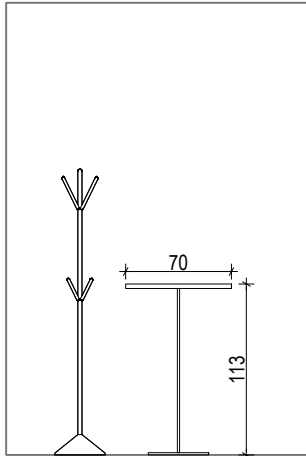

tipski elementi

P07
CRK - Hodnik pred
sprejemnico

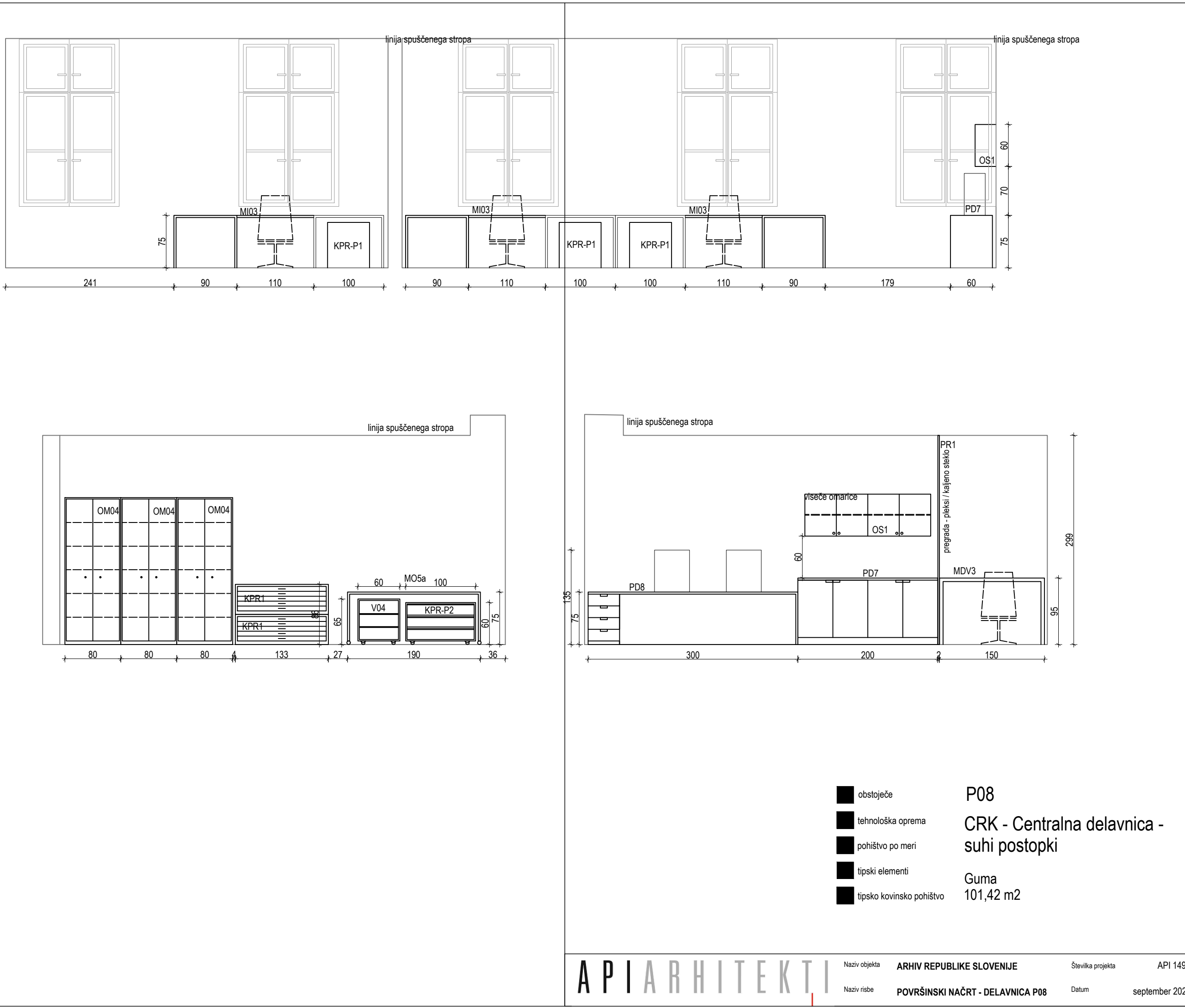
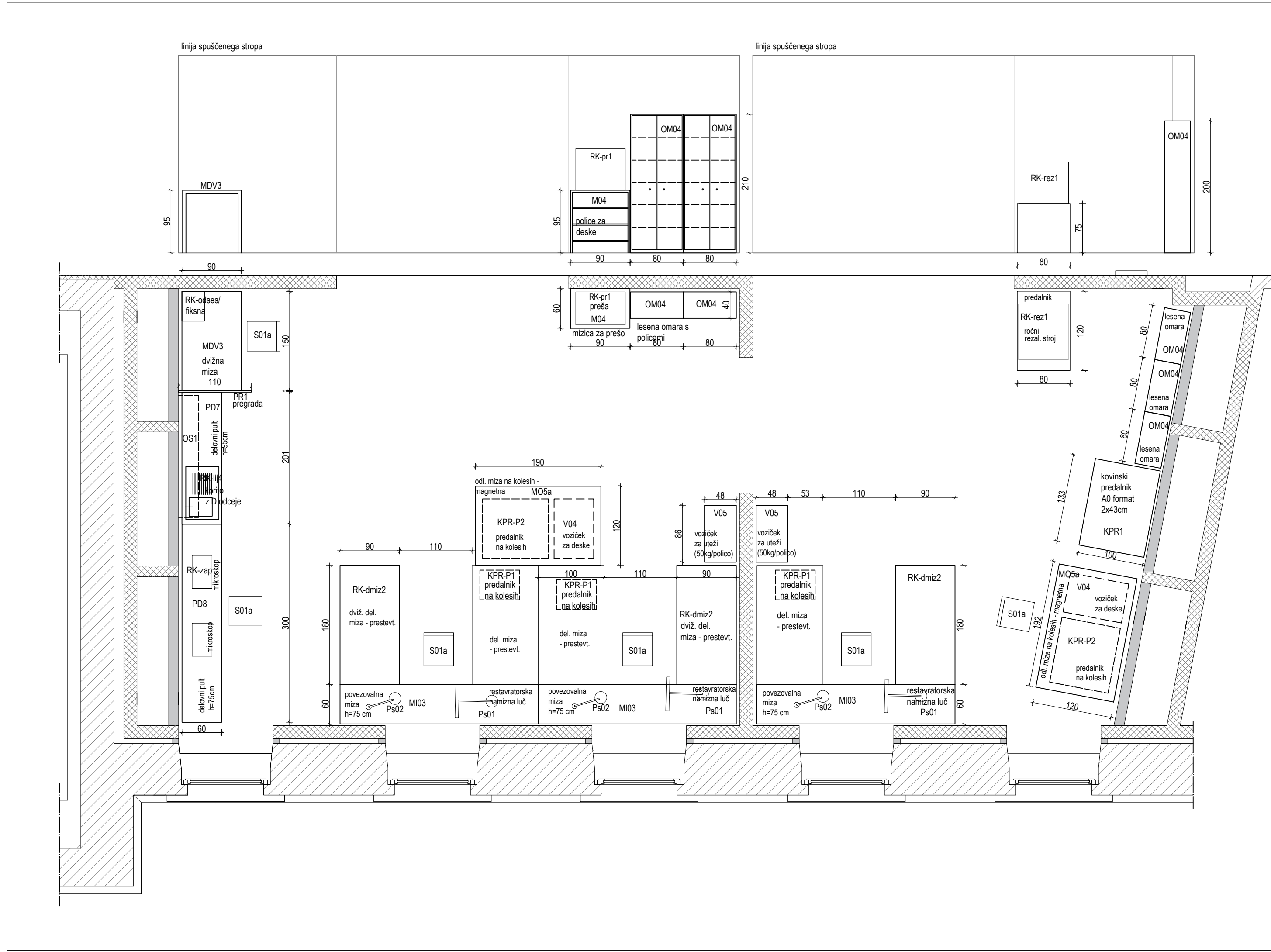



linija spušenega stropa

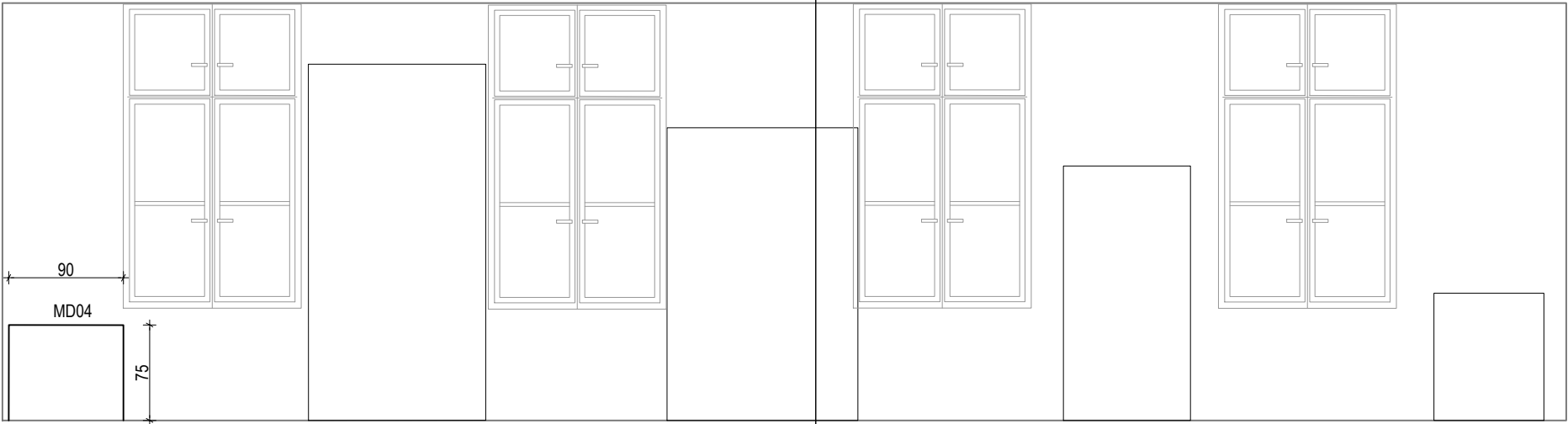

linija spušenega stropa

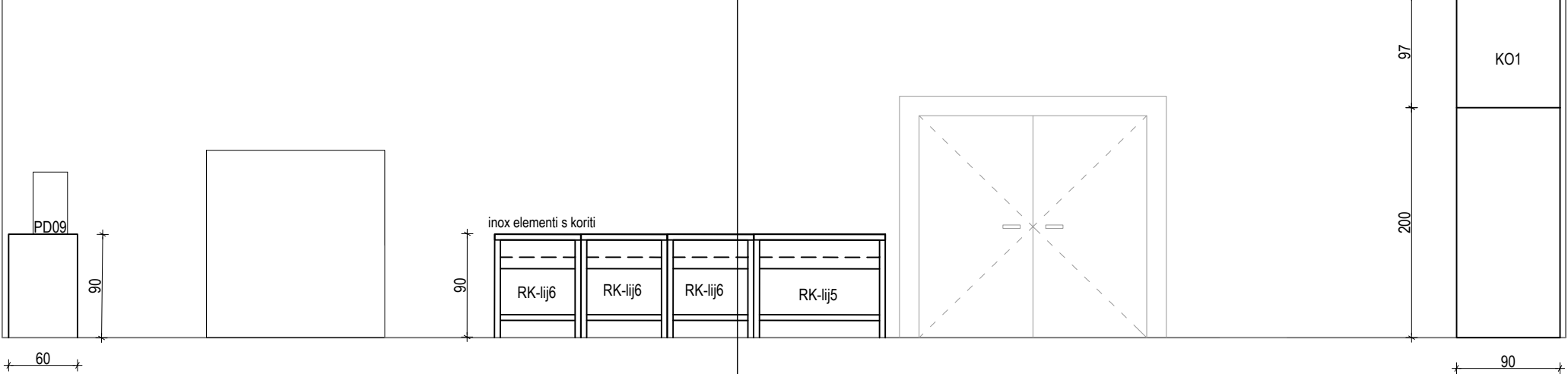

linija spušenega stropa

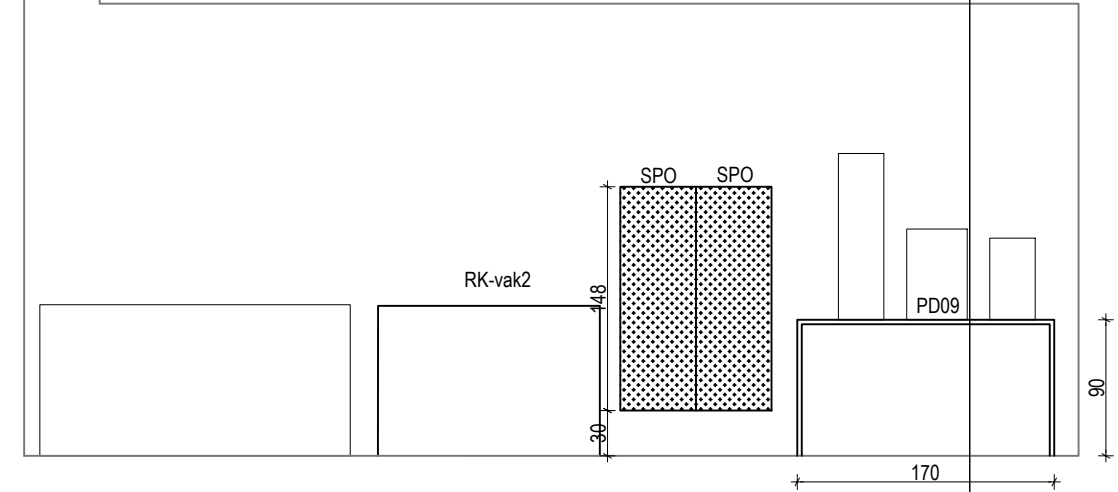

linija spušenega stropa

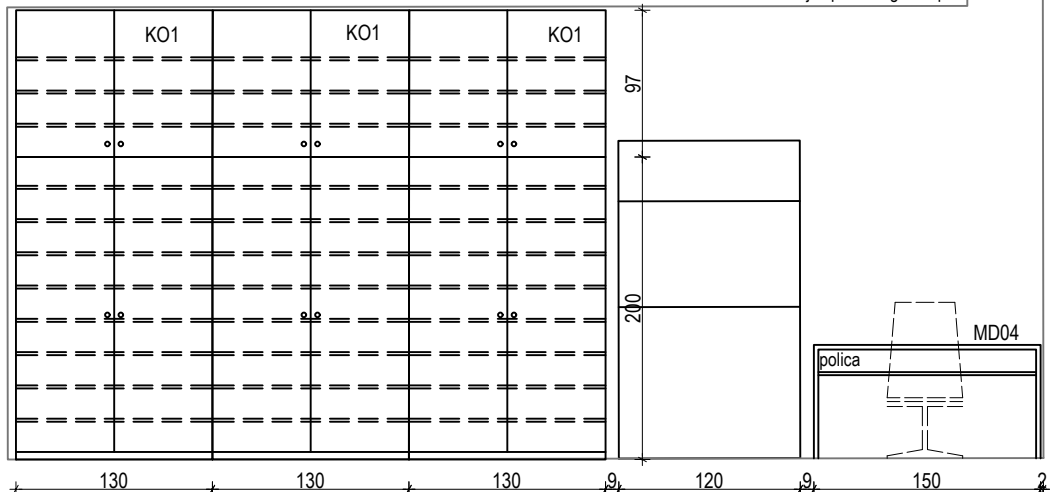

- obstoječe
- tehnološka oprema
- pohištvo po meri
- tipsko kovinsko pohištvo

P09
CRK - Mokri postopki
Guma
89,88 m2

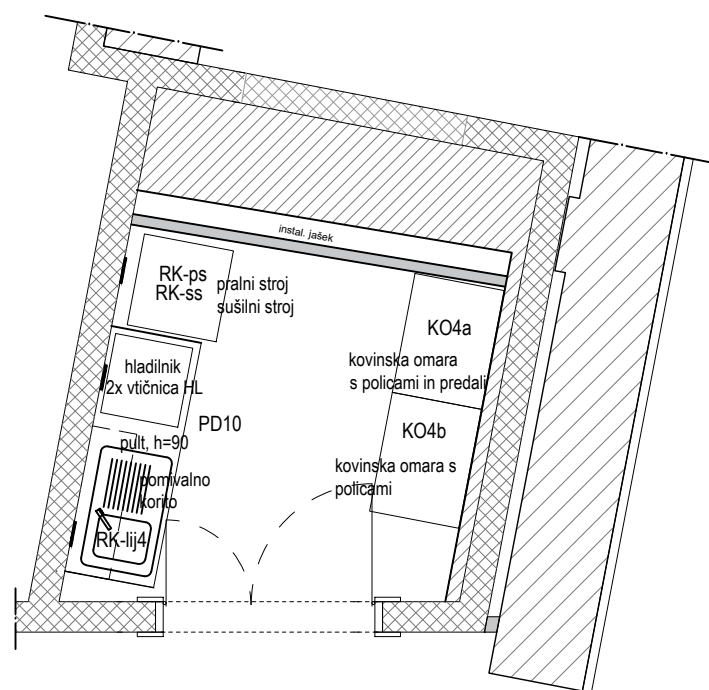

linija spuščenega stropa

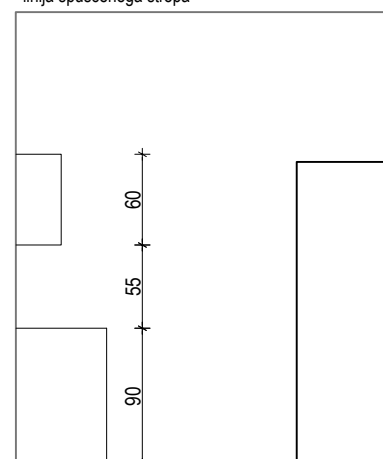

linija spuščenega stropa

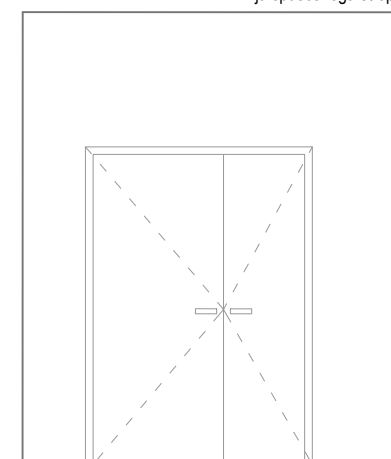

linija spuščenega stropa

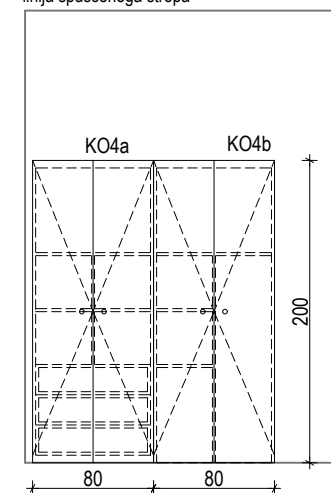

linija spuščenega stropa

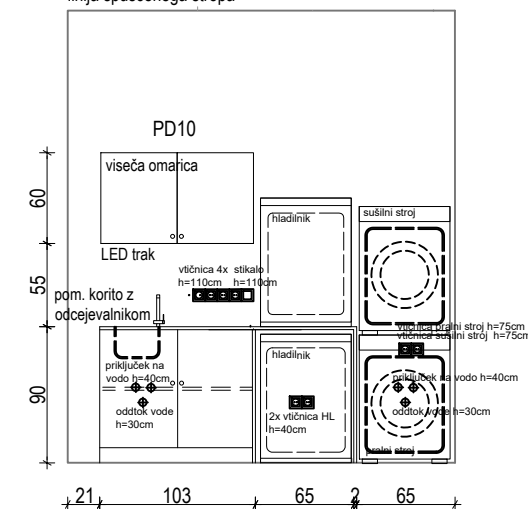

- obstoječe
- tehnološka oprema
- pohištvo po meri

P10
CRK - Mokri postopki
Guma
8,36 m2

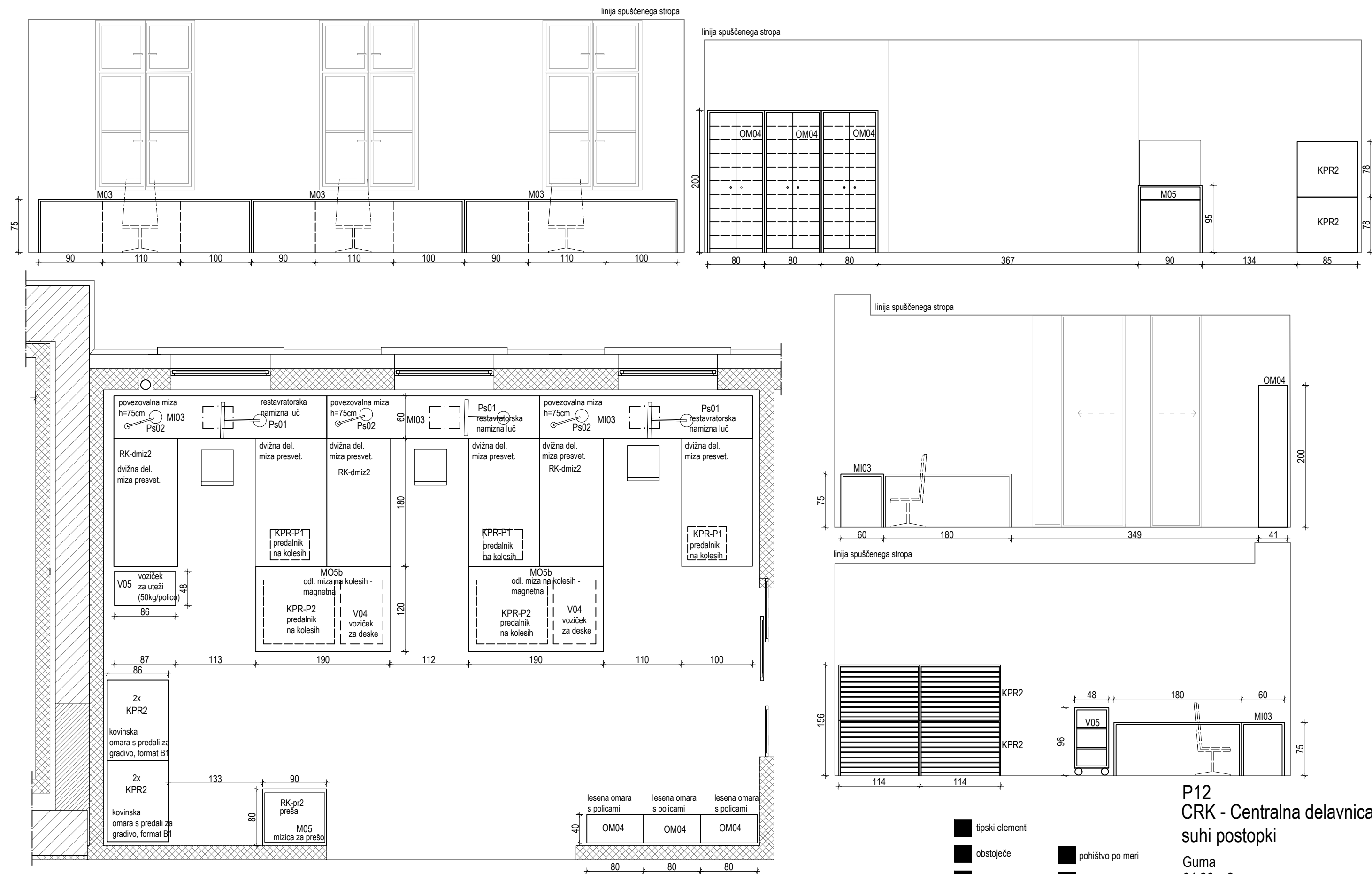

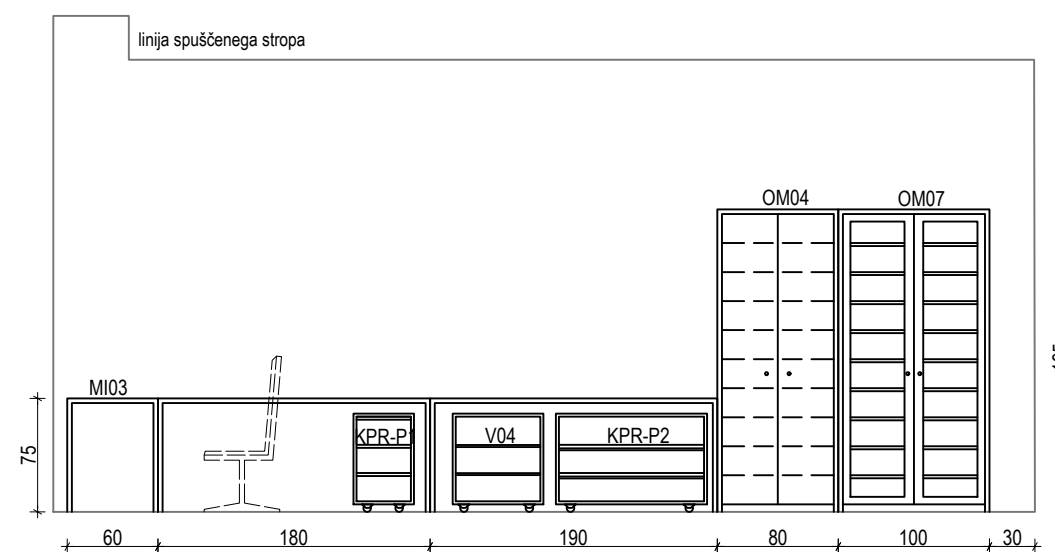
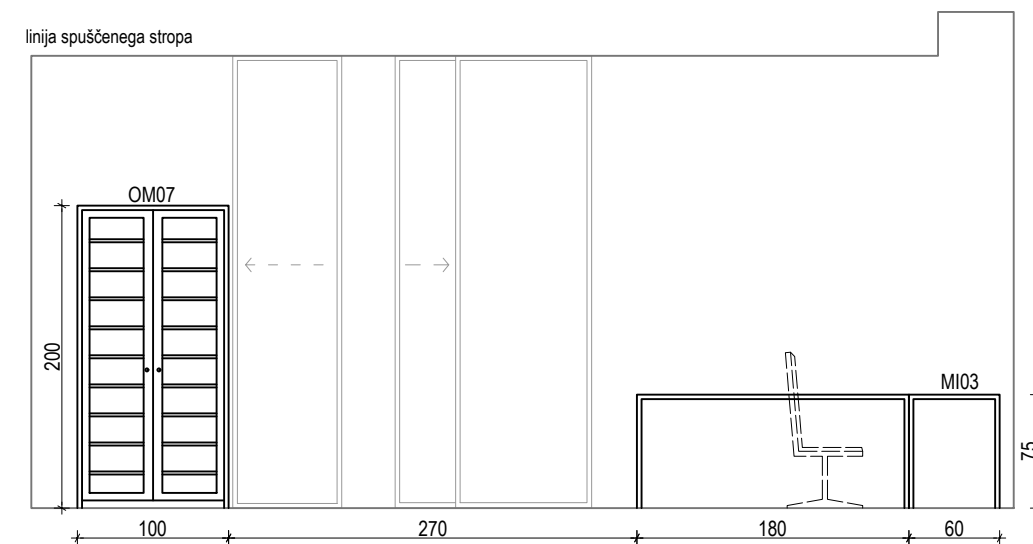
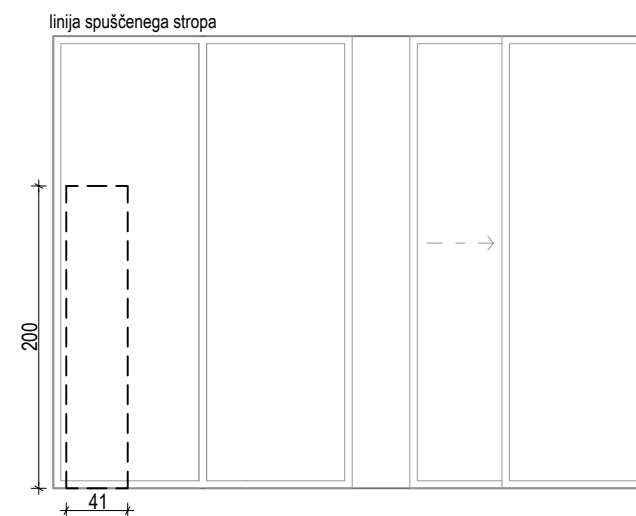
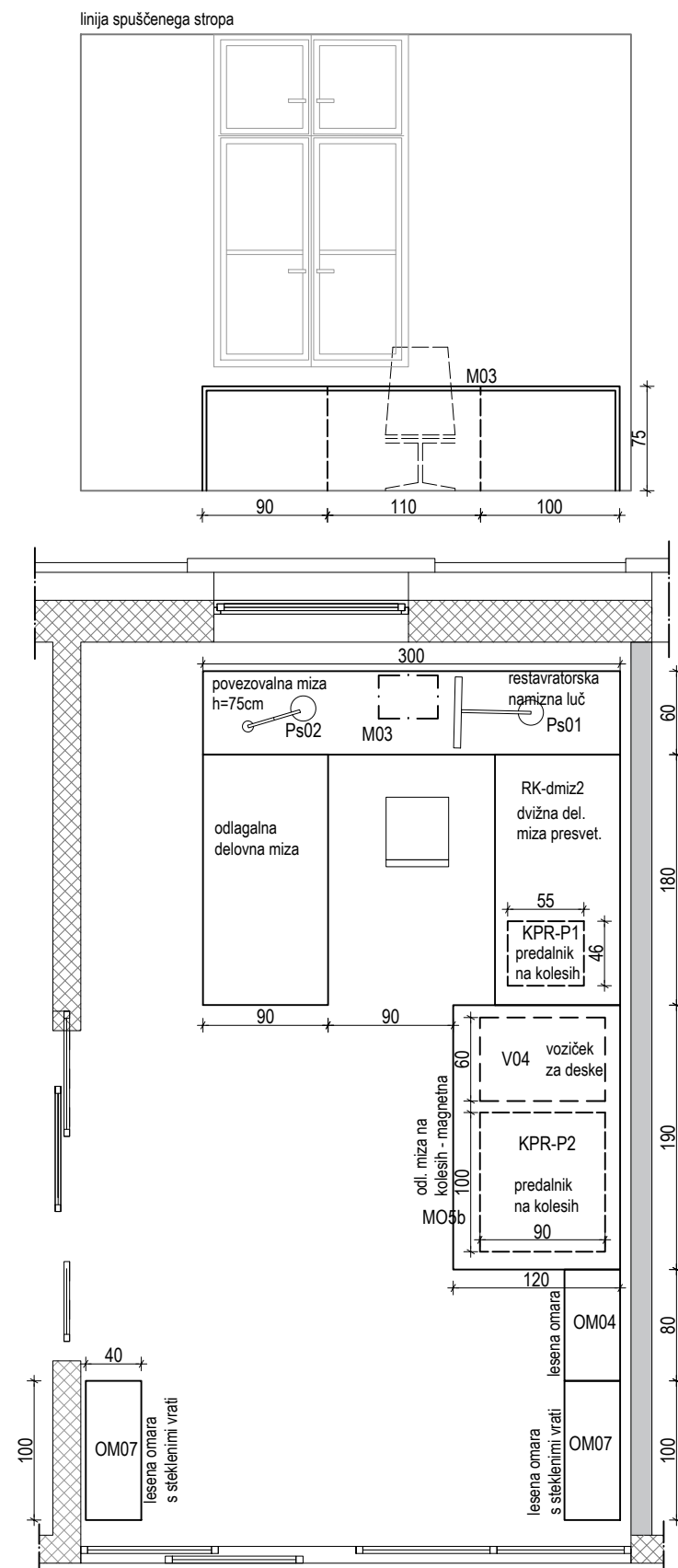

P12
RK - Centralna delavnica
- suhi postopki
Guma

- obstoječe
- tehnološka oprema
- pohištvo po meri
- tipsko kovinsko pohištvo

linija spuščenega stropa



linija spuščenega stropa

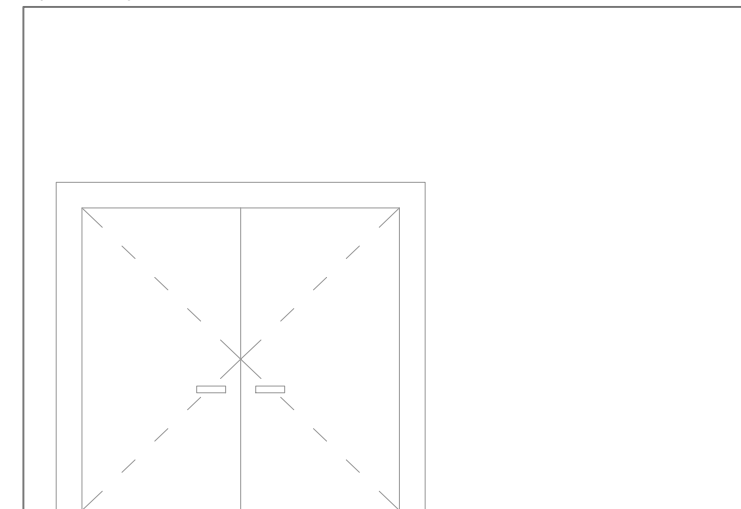

linija spuščenega stropa

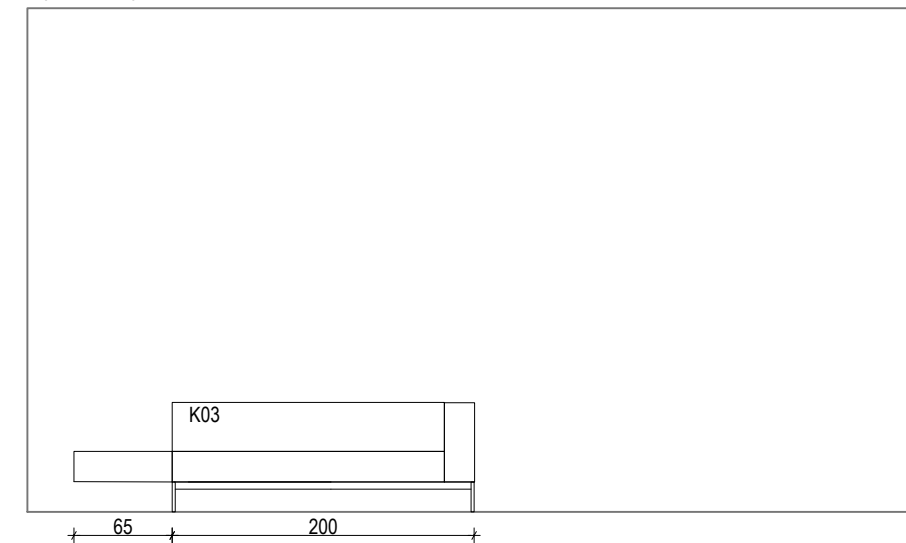

linija spuščenega stropa

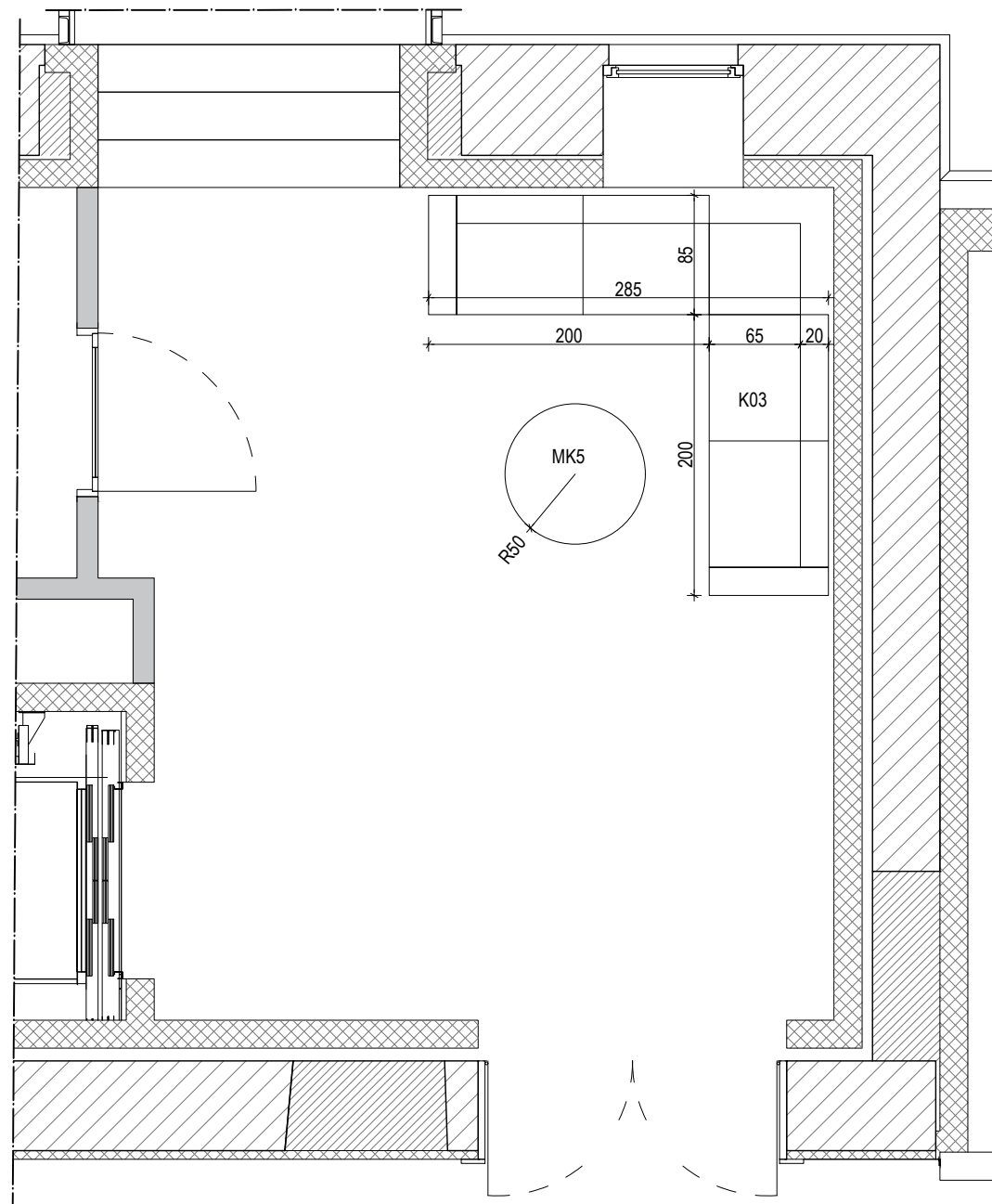
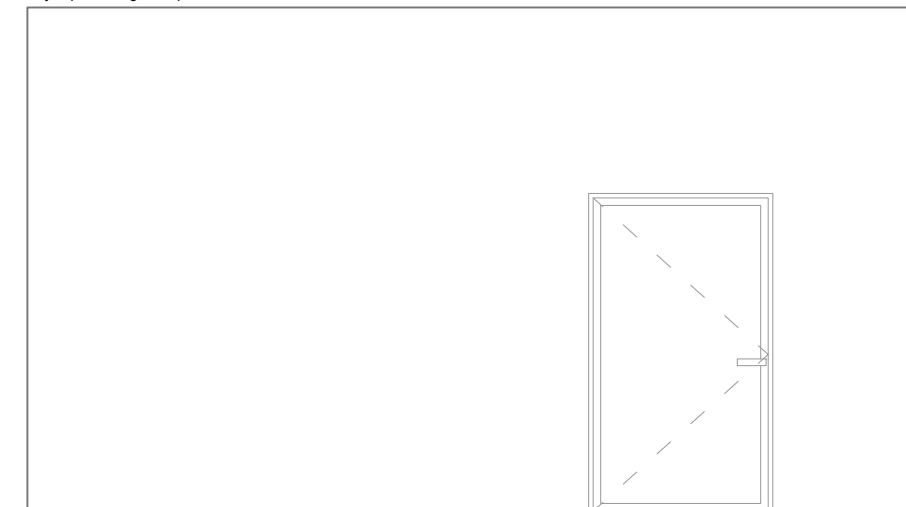

tipski elementi

P14
Hodnik

Kamen
32,04 m2

API ARHITEKTI

Naziv objekta	ARHIV REPUBLIKE SLOVENIJE	Številka projekta	API 1496
Naziv risbe	POVRŠINSKI NAČRT - HODNIK P14	Datum	september 2023

linija spuščene stropa

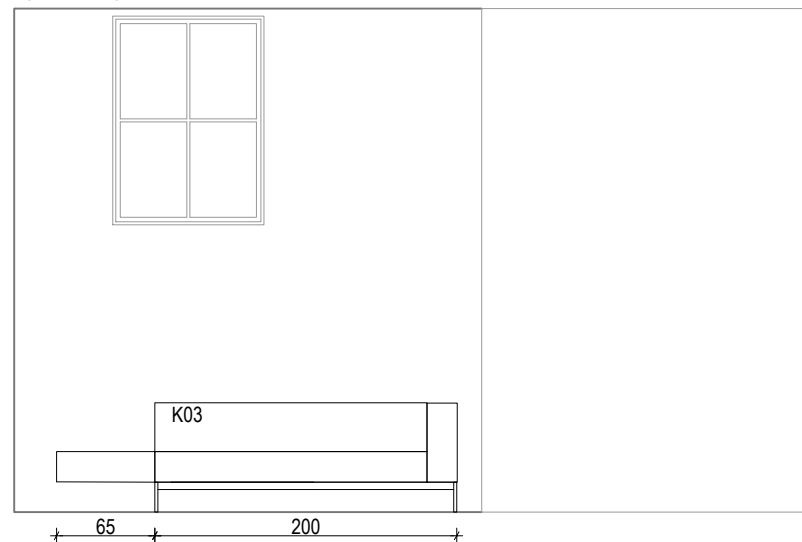

linija spuščene stropa

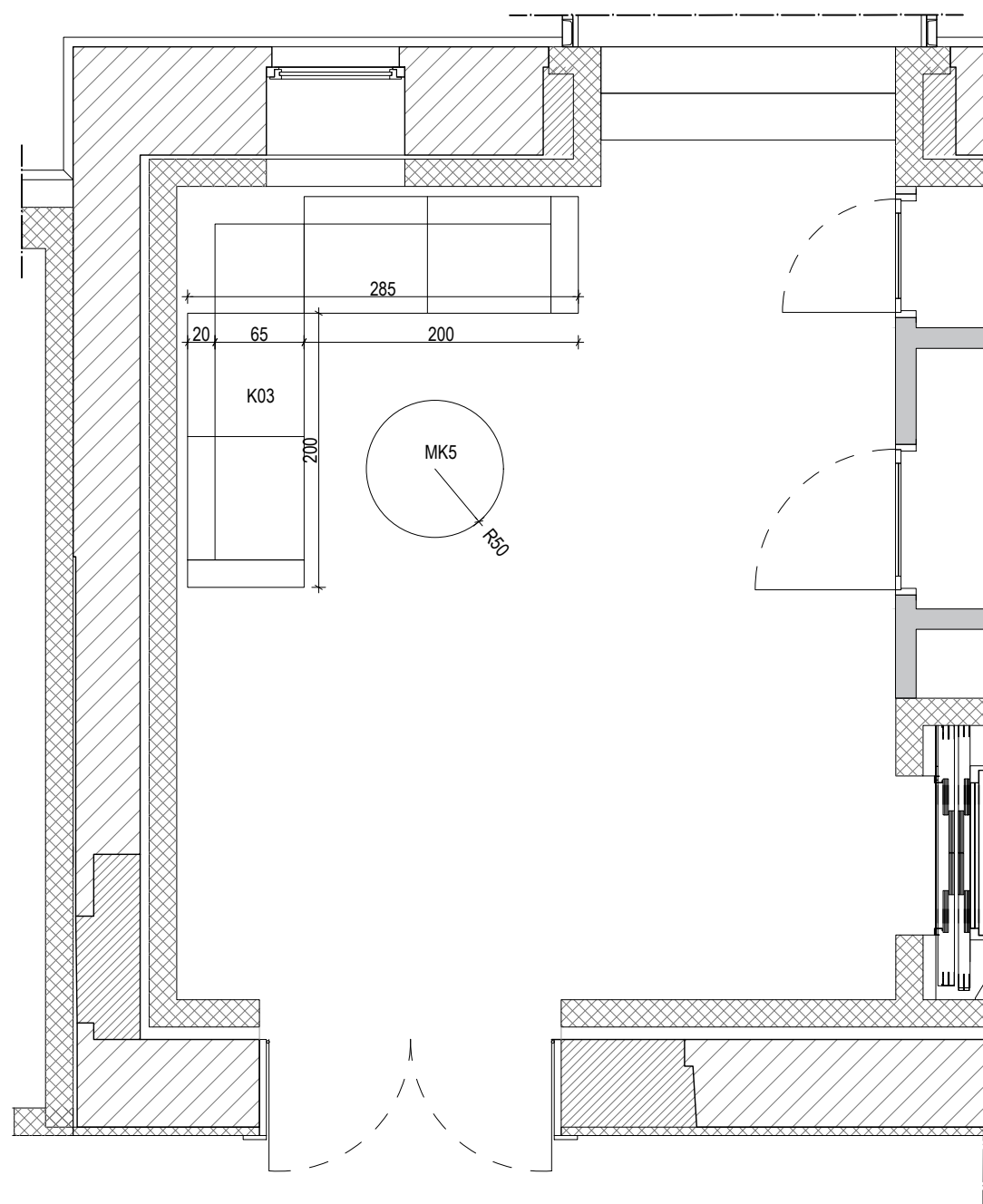
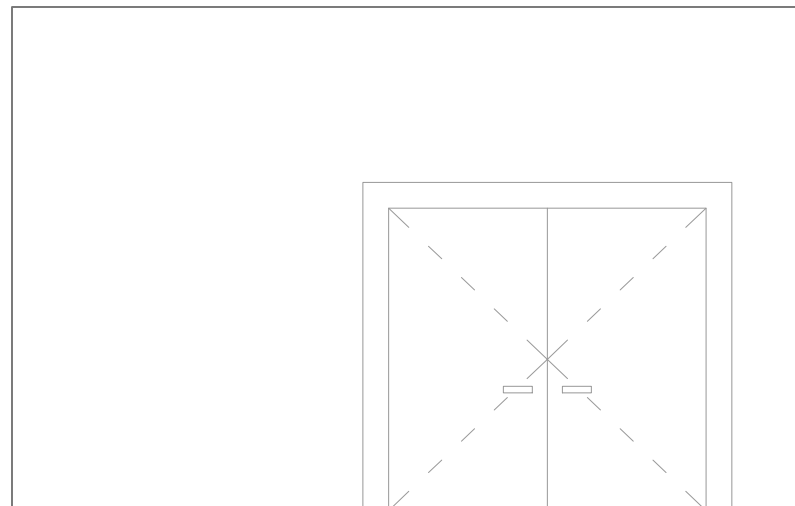

linija spuščene stropa

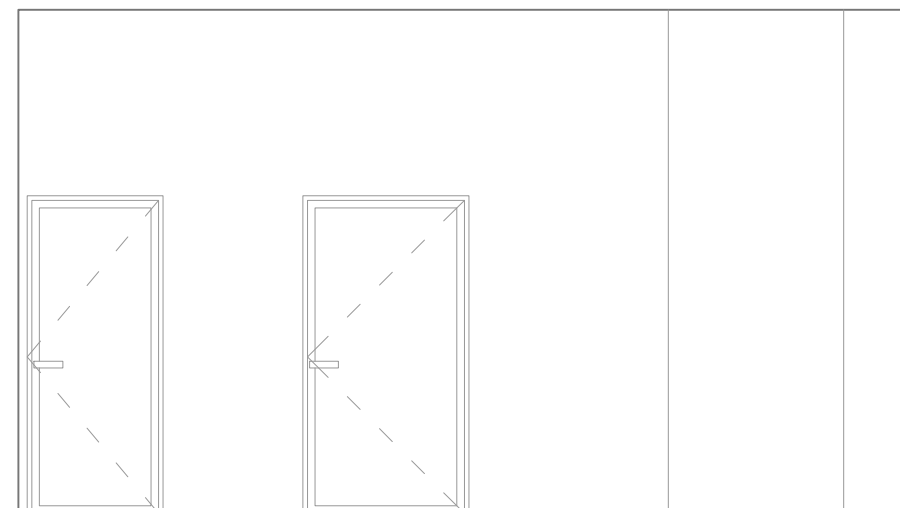

linija spuščene stropa

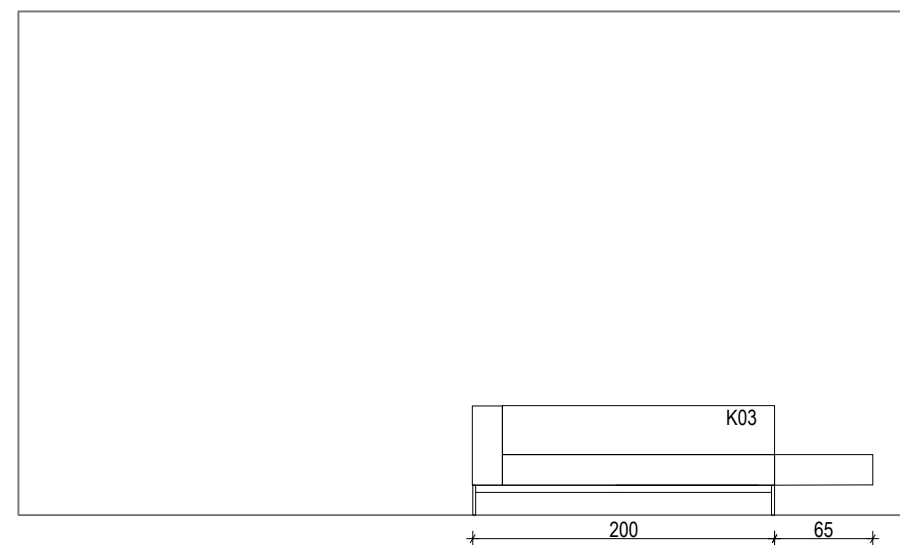

tipski elementi

P18
Hodnik
Kamen
33,30 m2

API ARHITEKTI

Naziv objekta	ARHIV REPUBLIKE SLOVENIJE	Številka projekta	API 1496
Naziv risbe	POVRŠINSKI NAČRT - HODNIK P18	Datum	september 2023

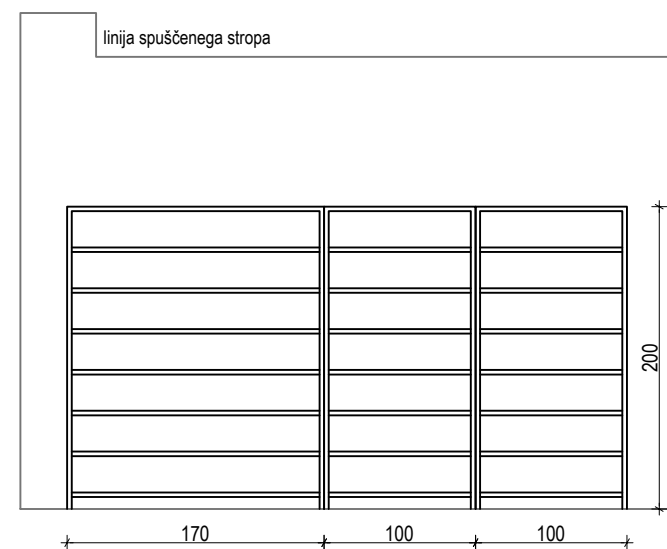
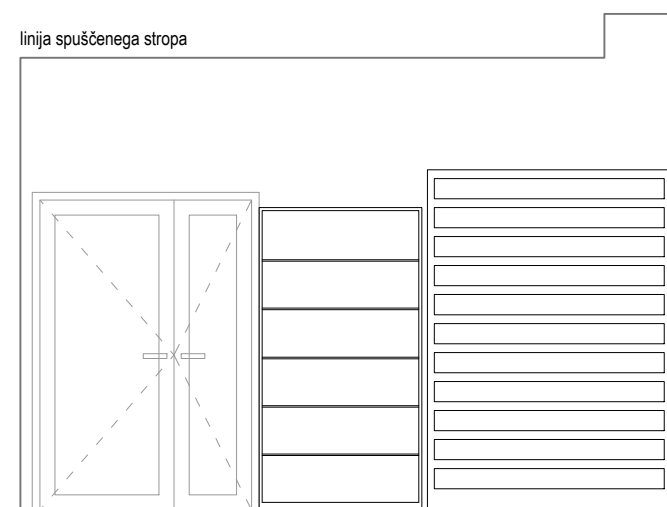
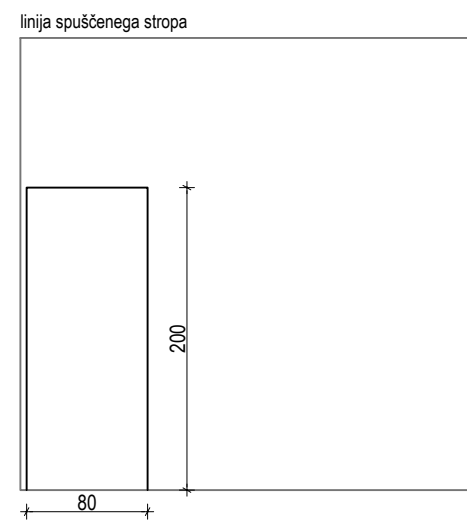
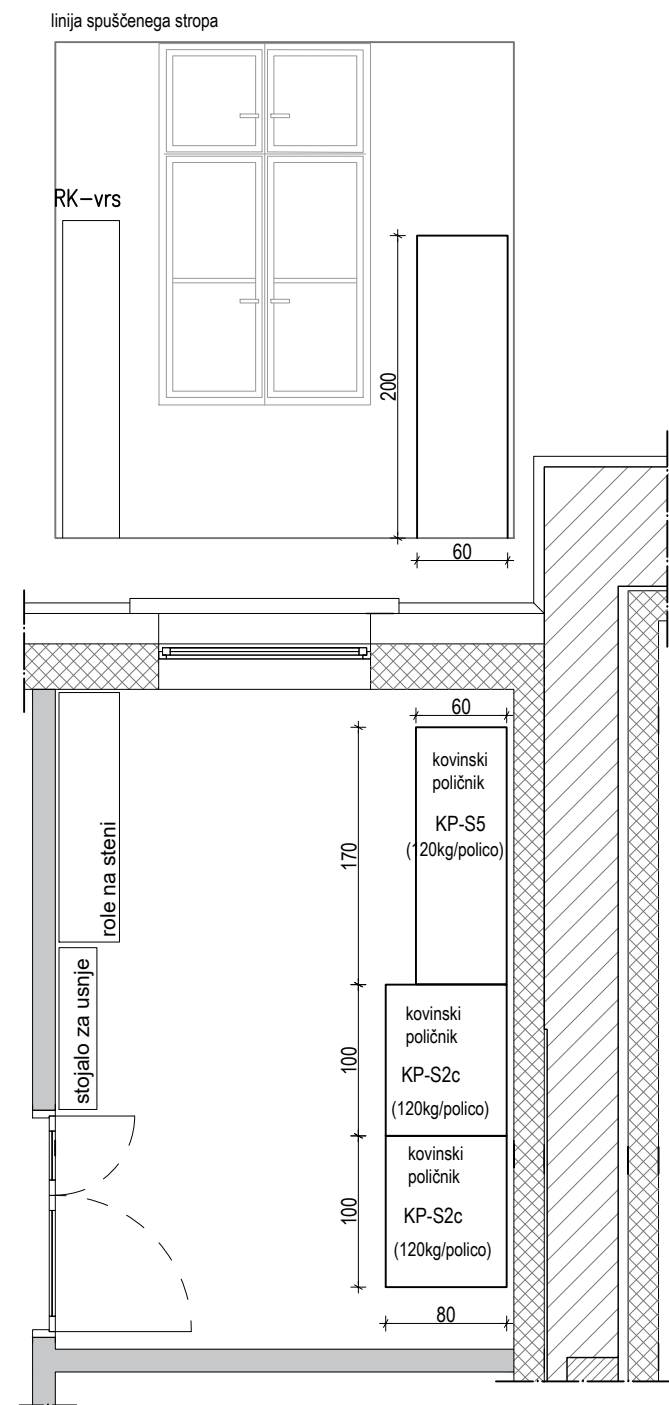

- obstoječe
- tipsko kovinsko pohištvo

P20
CRK - Priročno skladišče
Guma
13,24 m2

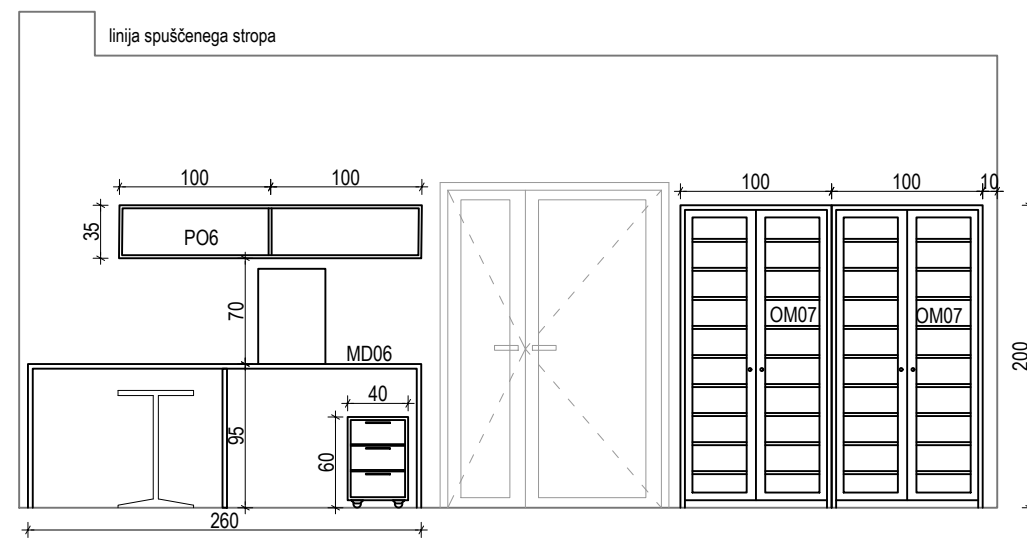
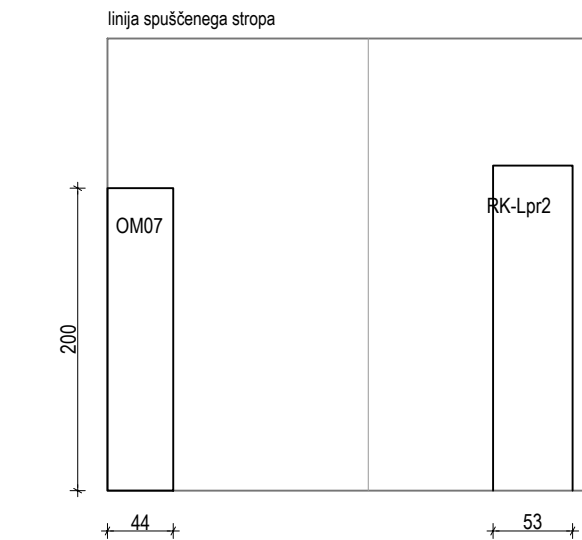
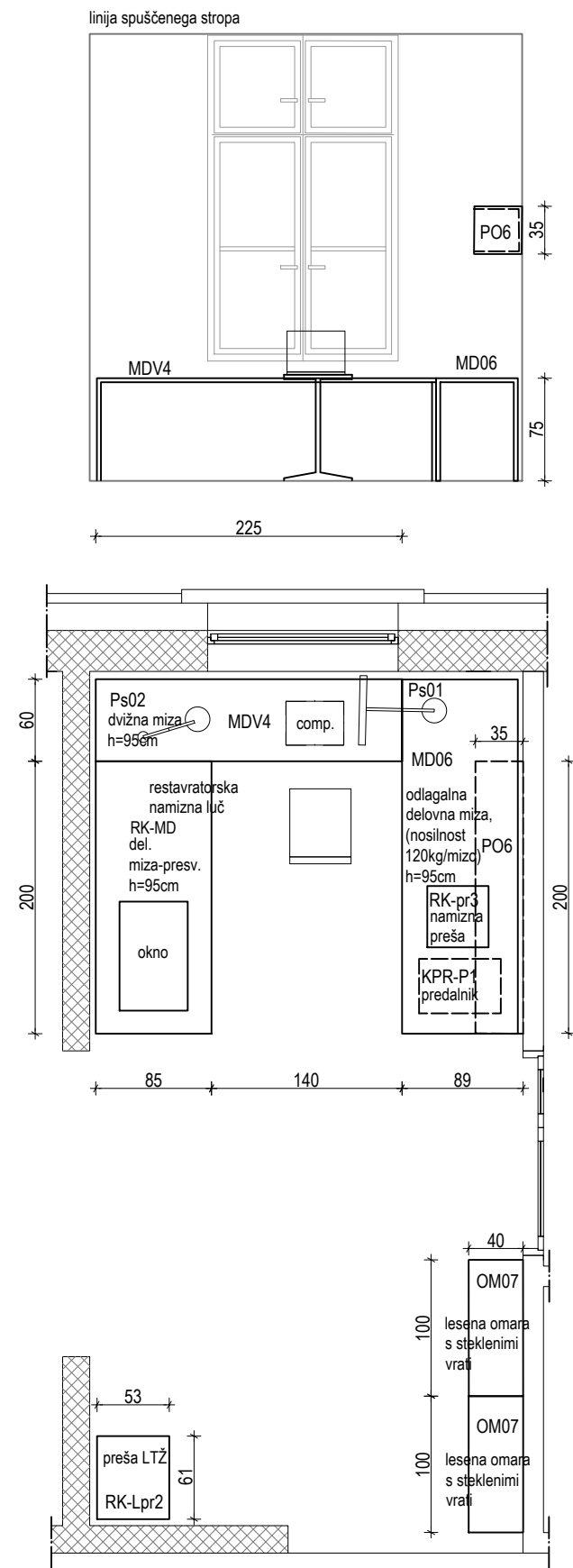

- tipski elementi
- obstoječe
- tehnološka oprema
- pohištvo po meri
- tipsko kovinsko pohištvo

P21
CRK - Knjigov.
Guma
20,73 m2

Technical drawing of a kitchen layout showing two identical units. Each unit consists of a base cabinet (MDV4) and an upper cabinet (MD06). The base cabinet has a width of 225 units, and the upper cabinet has a width of 85 units. The units are labeled P06.

Technical drawing of the MD05 desk unit. The drawing includes a front view and a side view. The front view shows a desk with a width of 400 and a height of 95. The desk has a central storage compartment labeled "boks" and two side compartments. The left side compartment has a label "predali" and the right side compartment has a label "izvlačne police". The side view shows the desk's profile with a label "MD05" and a height of 95. The desk is composed of several parts, including a main desk body and a side unit labeled "RK-rez3". The side unit has a label "RK-rol2" and a height of 95. The desk is shown in a light gray color.

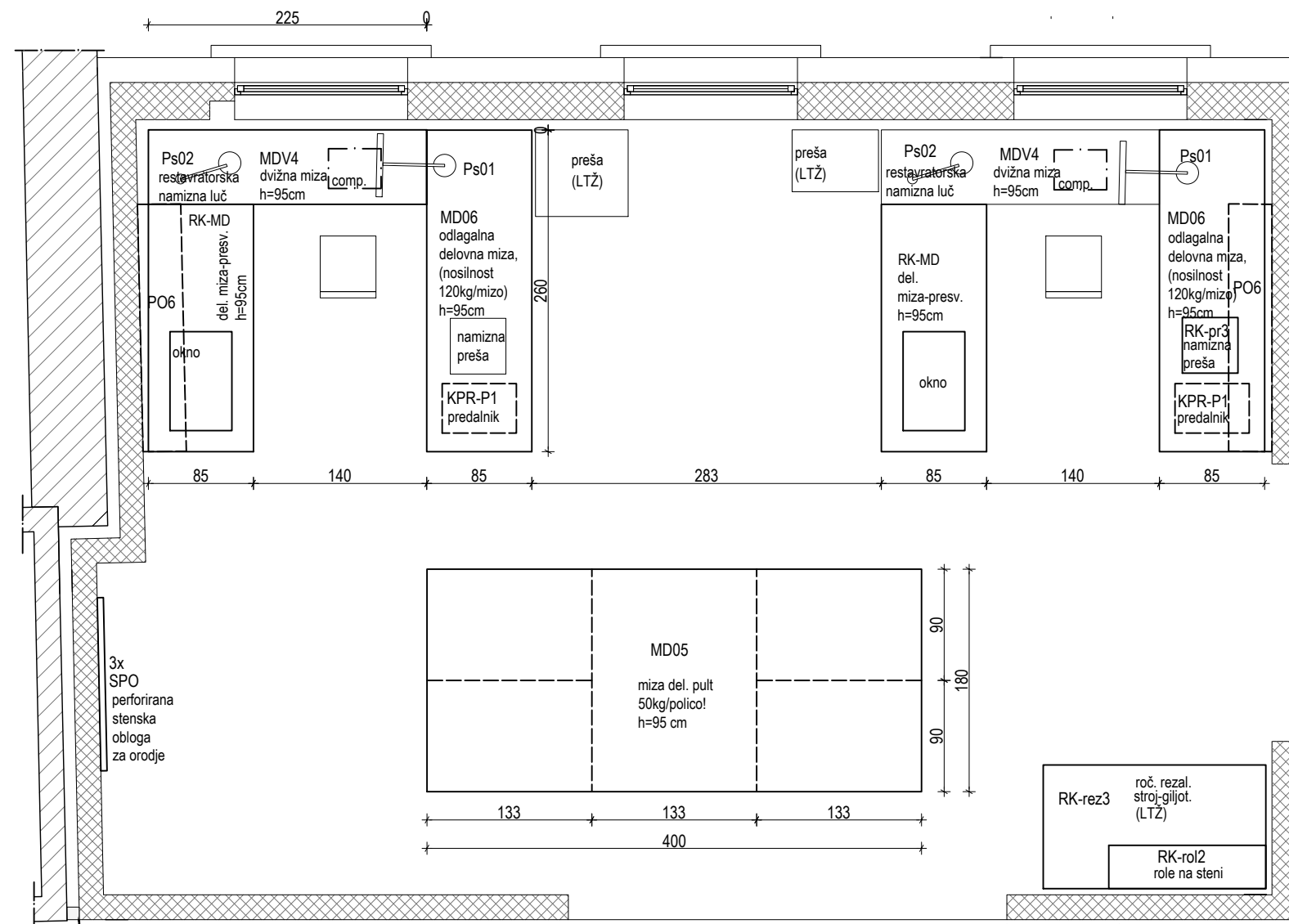

The technical drawing consists of two views of a wall section:

- Left View (Cross-section):** A rectangular wall with a total height of 148 and a total width of 150. The wall is divided into three vertical sections, each 50 wide, labeled "SPO" at the top. The entire wall area is filled with a stippled pattern.
- Right View (Side Elevation):** Shows the wall's profile with a total height of 95. The top edge has a width of 100 on the left and 100 on the right. A horizontal line at height 70 from the base contains a rectangular opening labeled "PO6". To the right of the main wall is a smaller section labeled "MDV4". A dashed line indicates a vertical element labeled "S01a" with a horizontal base of 200 and a vertical height of 95.

Technical drawing of the 'Stol' (Table) showing front and side views with dimensions and component labels.

Front View Dimensions:

- Overall width: 260
- Top section width segments: 100 and 100
- Top section height: 35
- Lower section height: 70
- Base height: 95

Labels and Components:

- PO6 (Top right panel)
- RK-pr3 (Middle section)
- MD06 (Lower section)
- KPR-P1 (Roller casters)
- RK-rol2 (Right side panel)
- RK-rez3 (Right side panel)





Side View Dimensions:

- Overall height: 95

Additional Information:

- tehnološka oprema (technical equipment)

P22
CRK - Knjigov.
Guma
58,94 m2

	tehnološka oprema
	pohišto po meri
	tipski elementi
	tipsko kovinsko pohišto

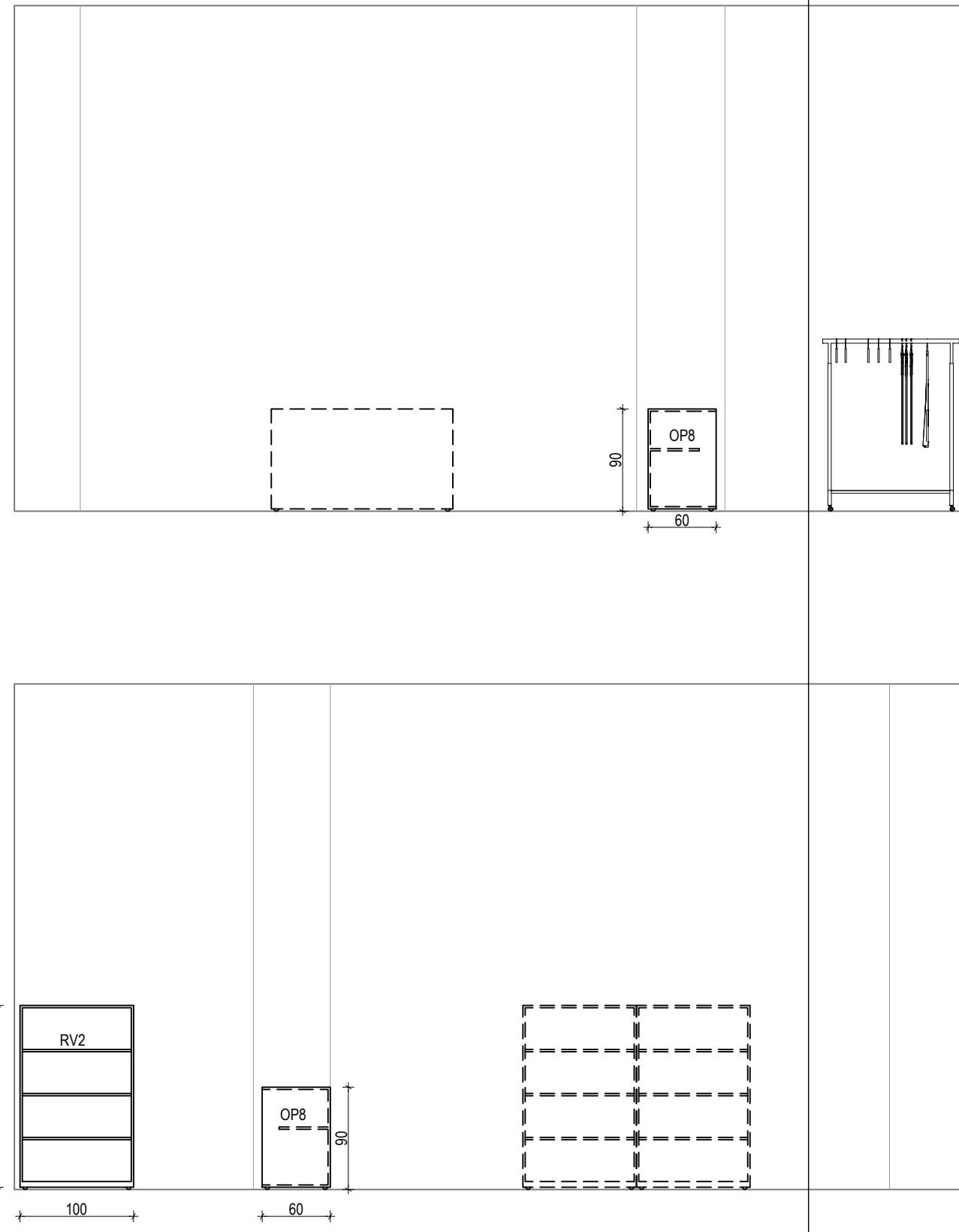
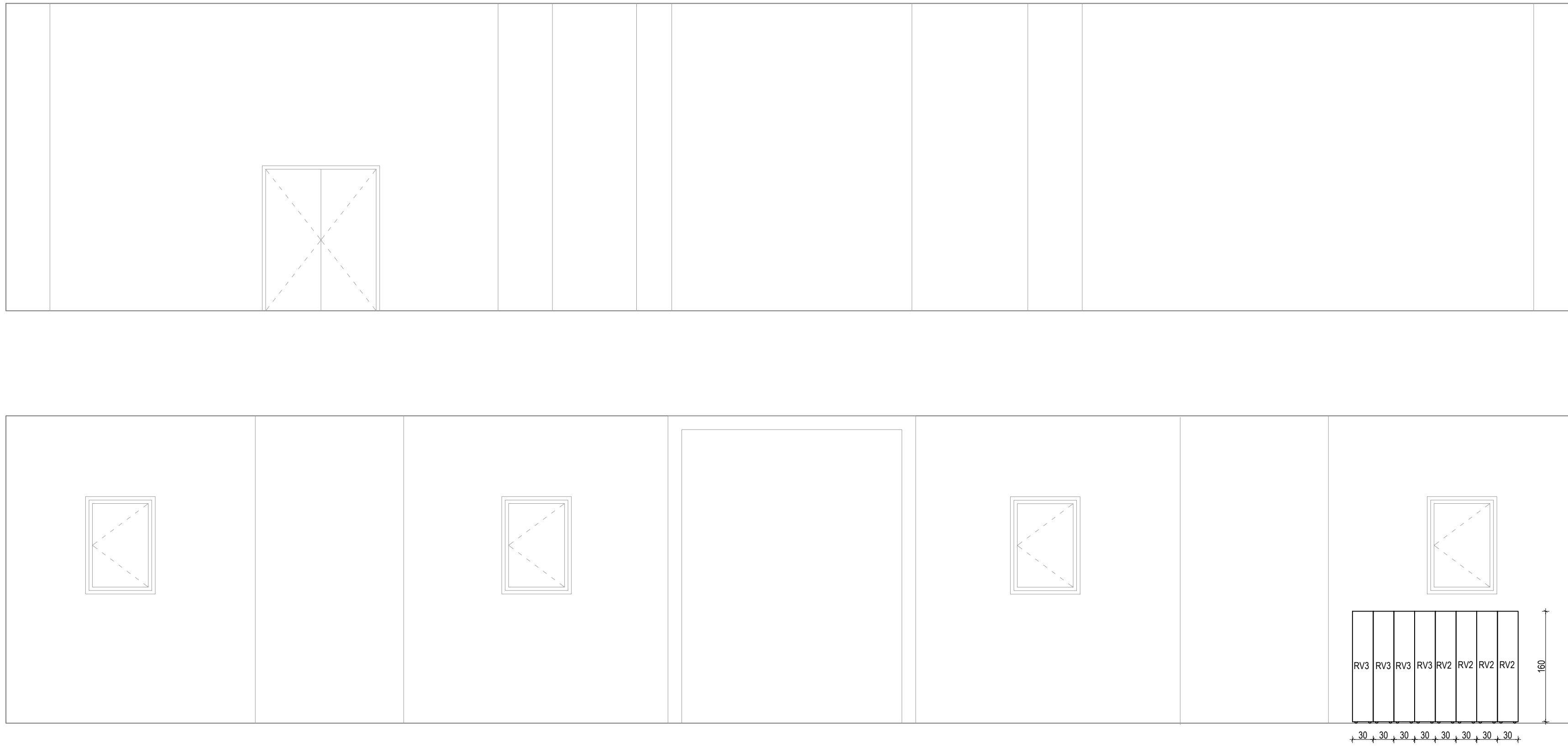
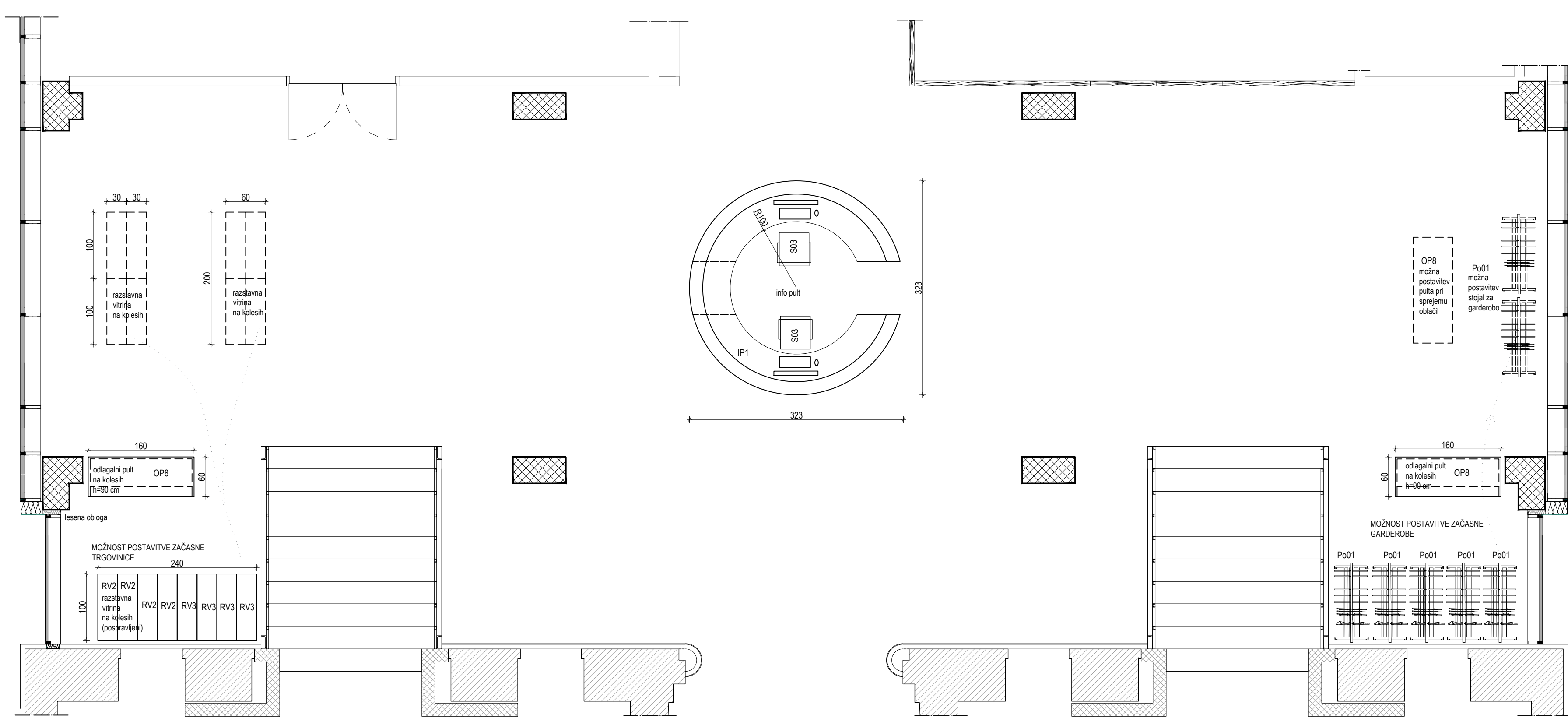

P24
SK - Vhodna avla
Kamen
228,67 m2

tipski elementi
pohištvo po meri

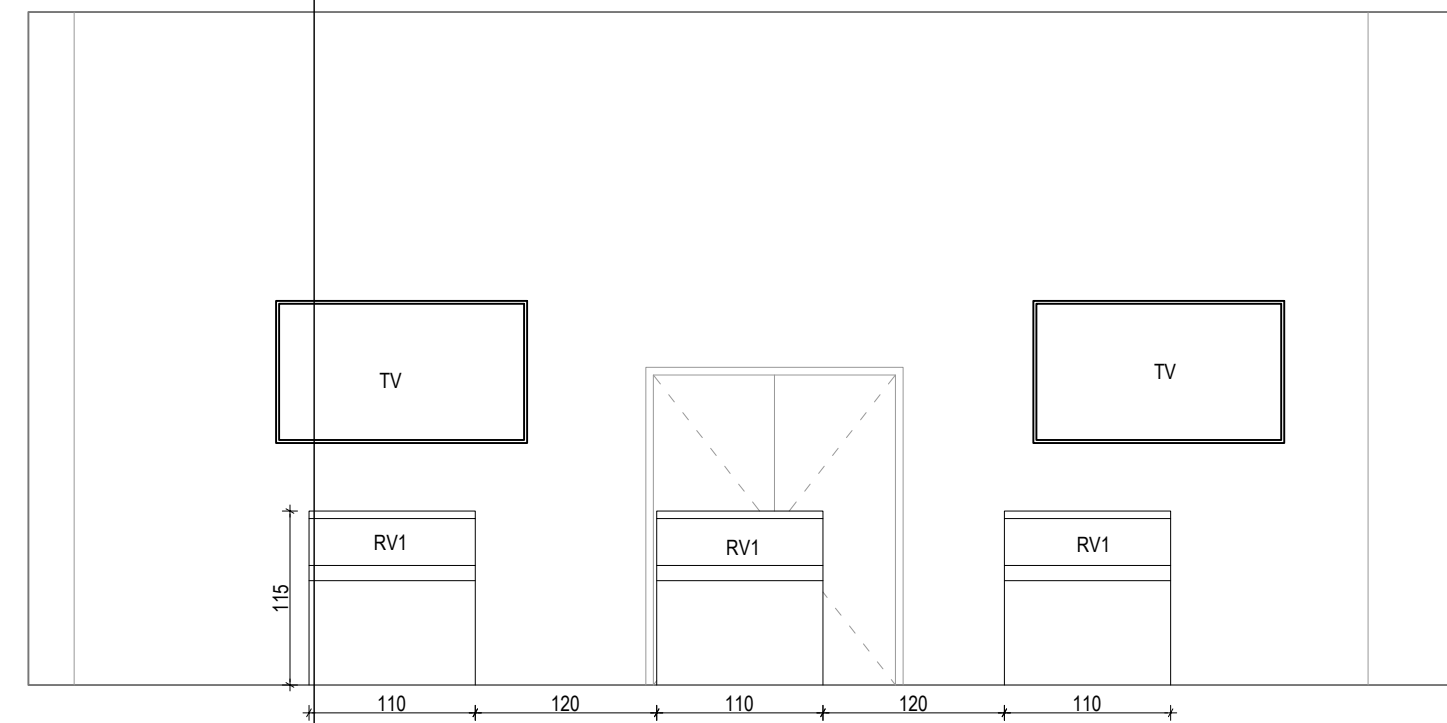
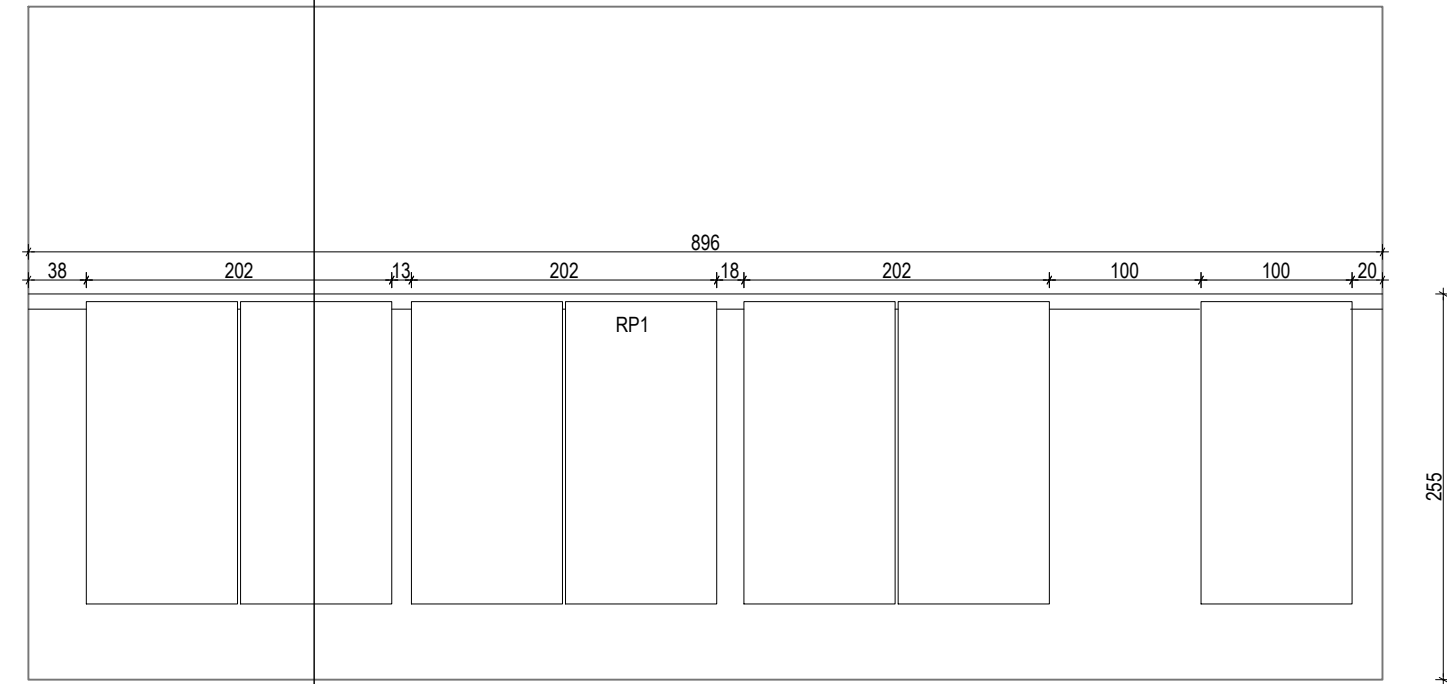
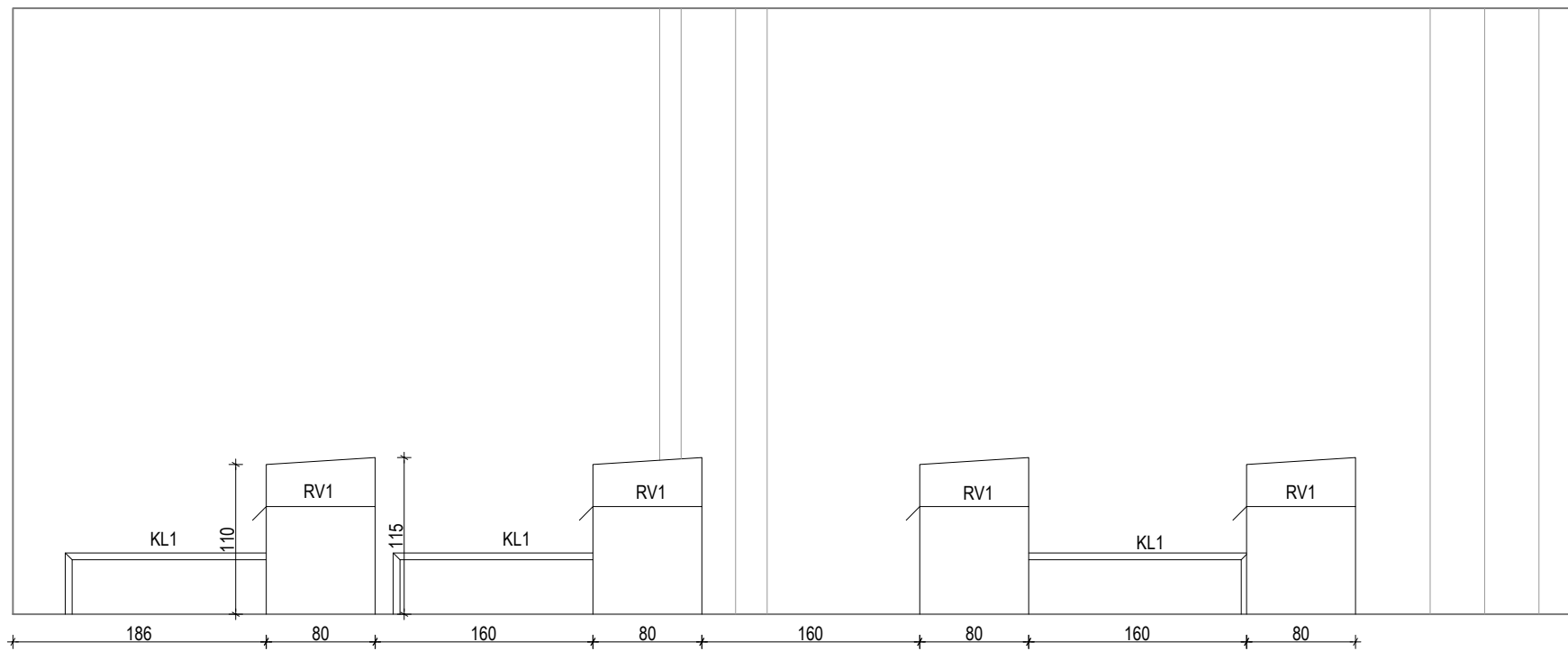
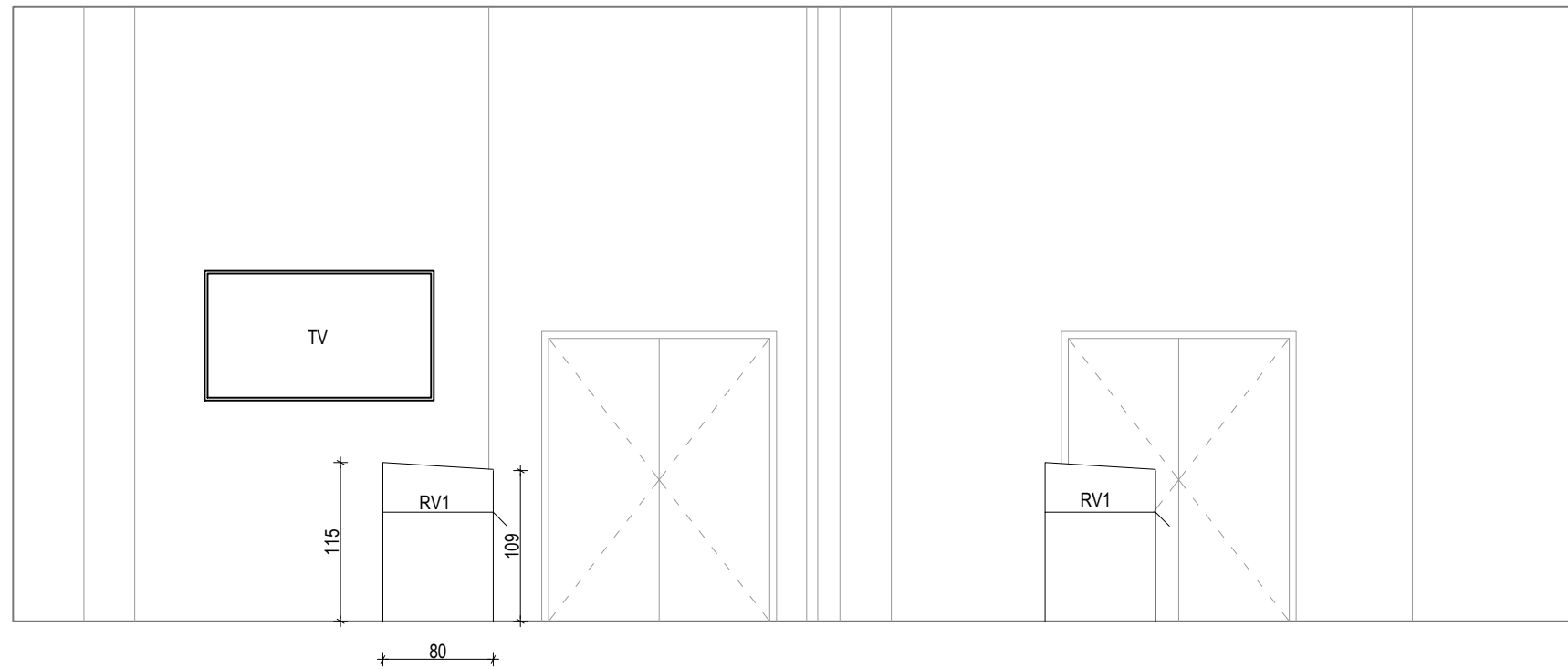

P26
SK - Razstavni prostor
Kamen
104,10 m²

- tehnološka oprema
- tipski elementi
- pohištvo po meri

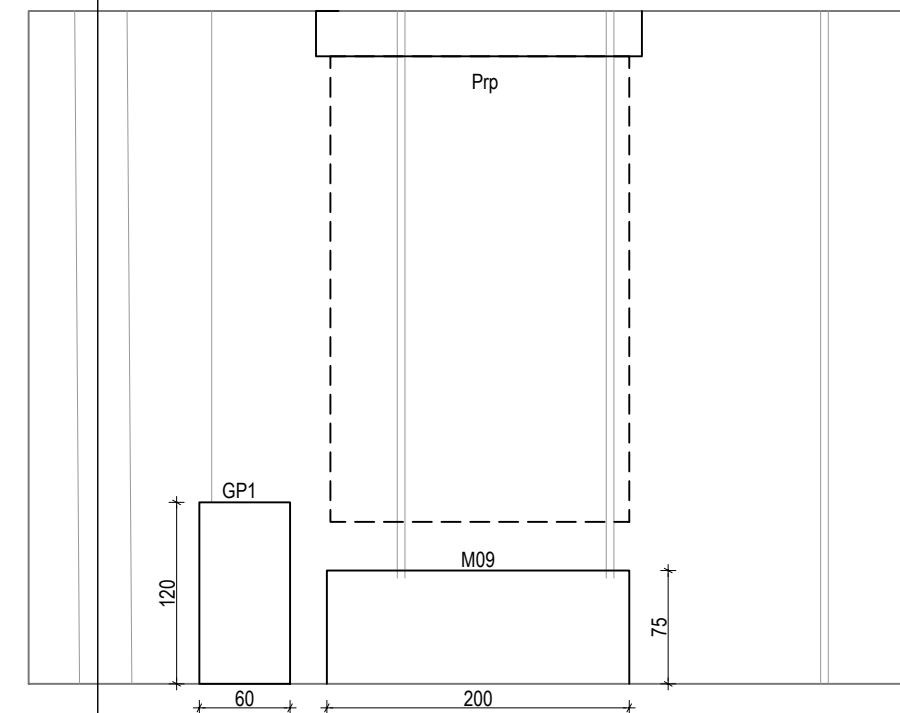
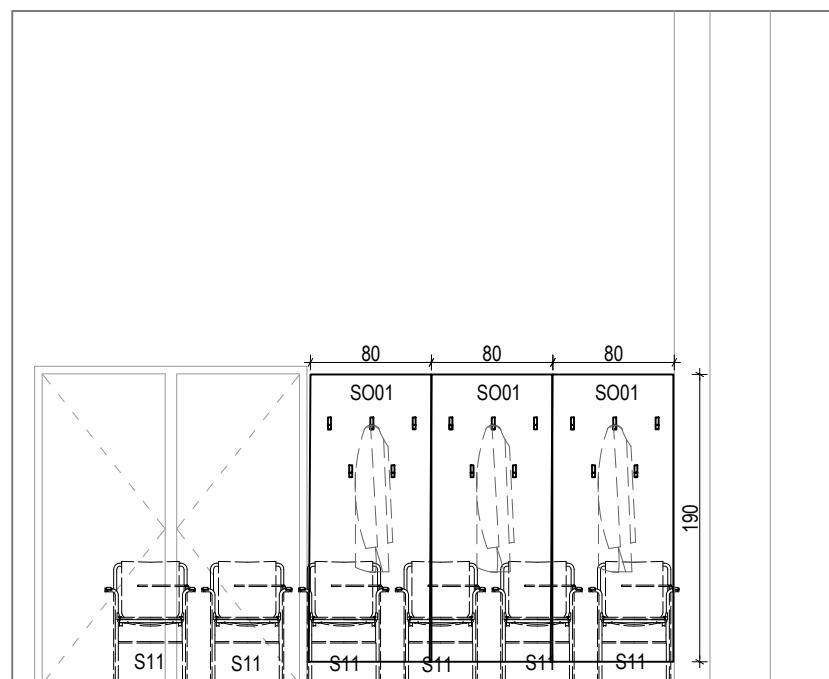
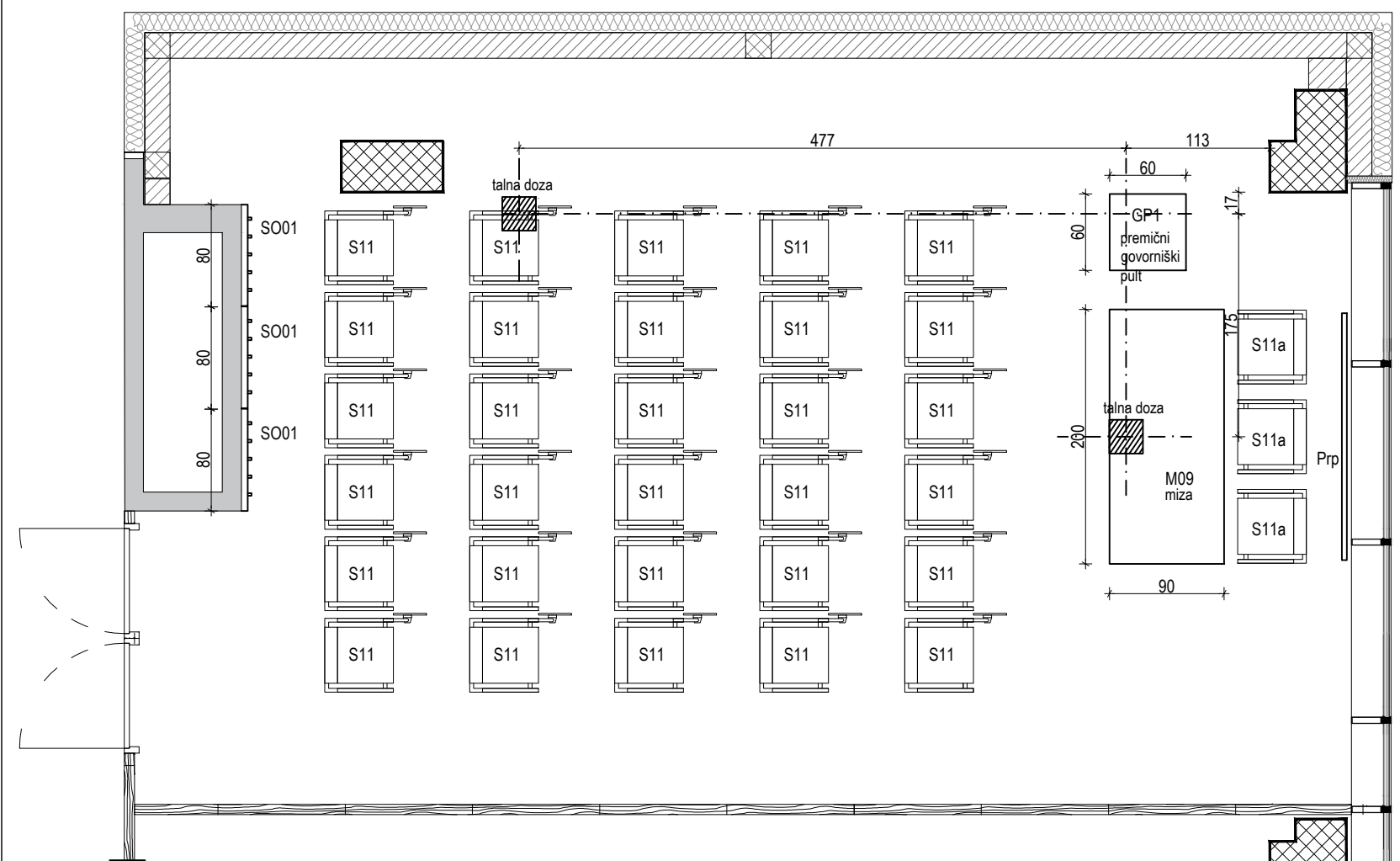
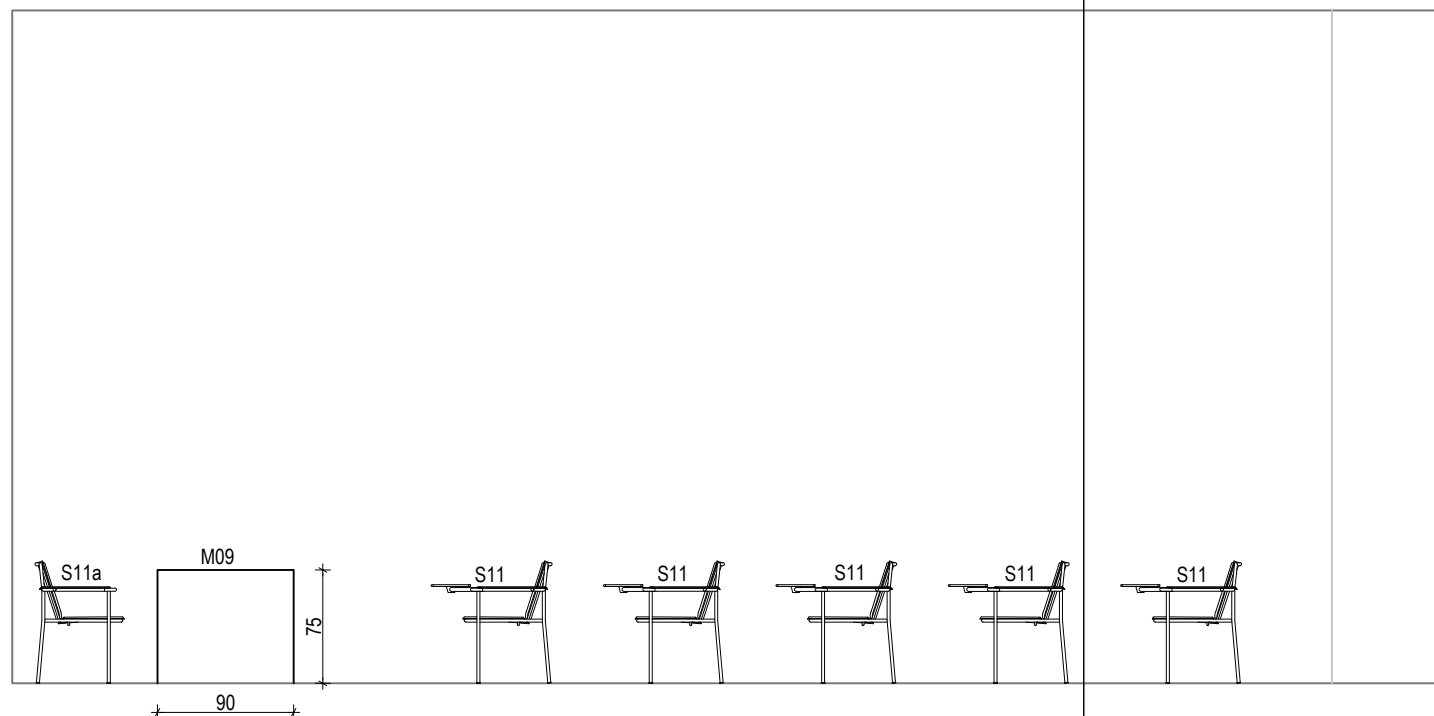
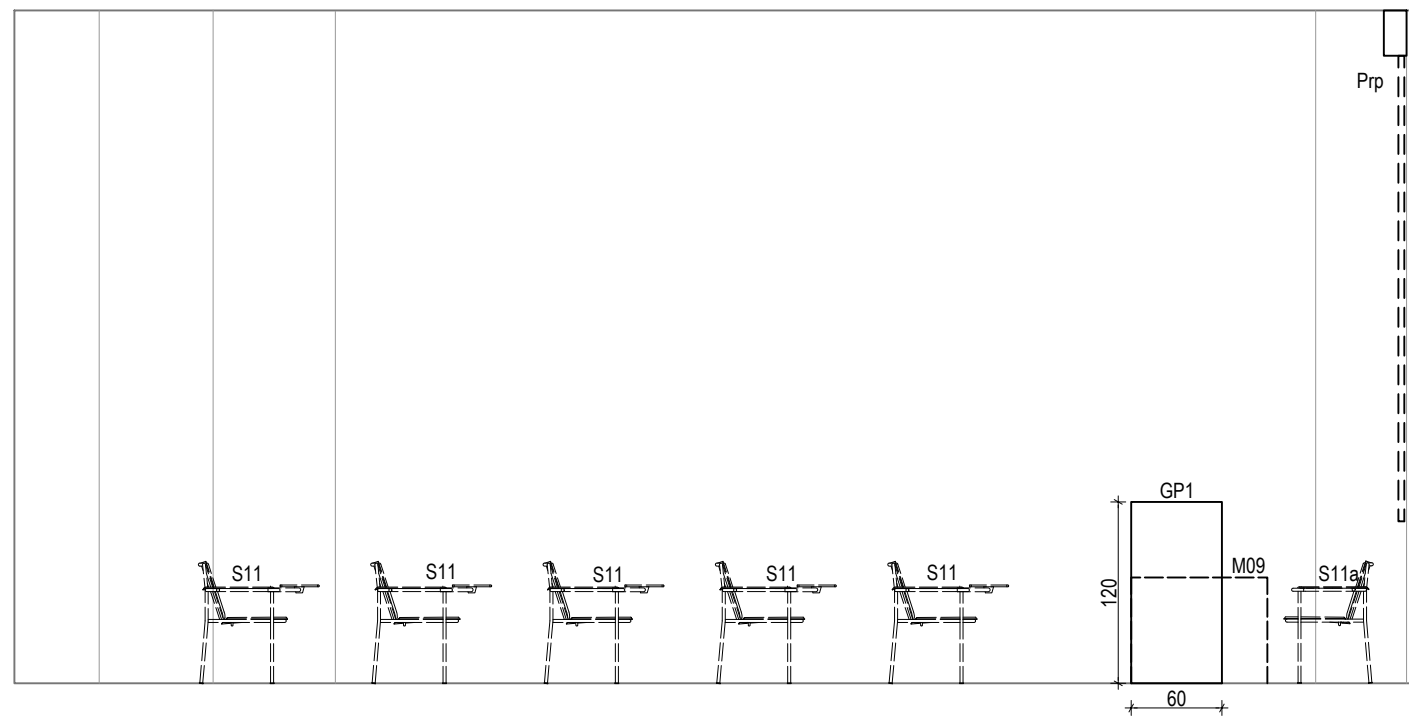

- tipsko pohištvo
- tehnološka oprema
- tipski elementi
- pohištvo po meri

P27
SK - Predavalnica 1
Kamen
52,54 m2

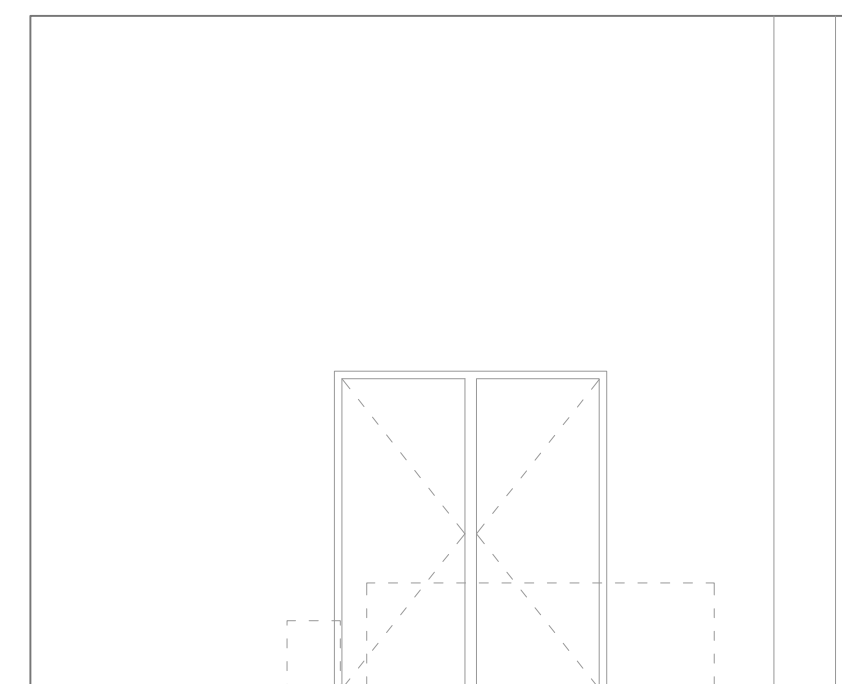
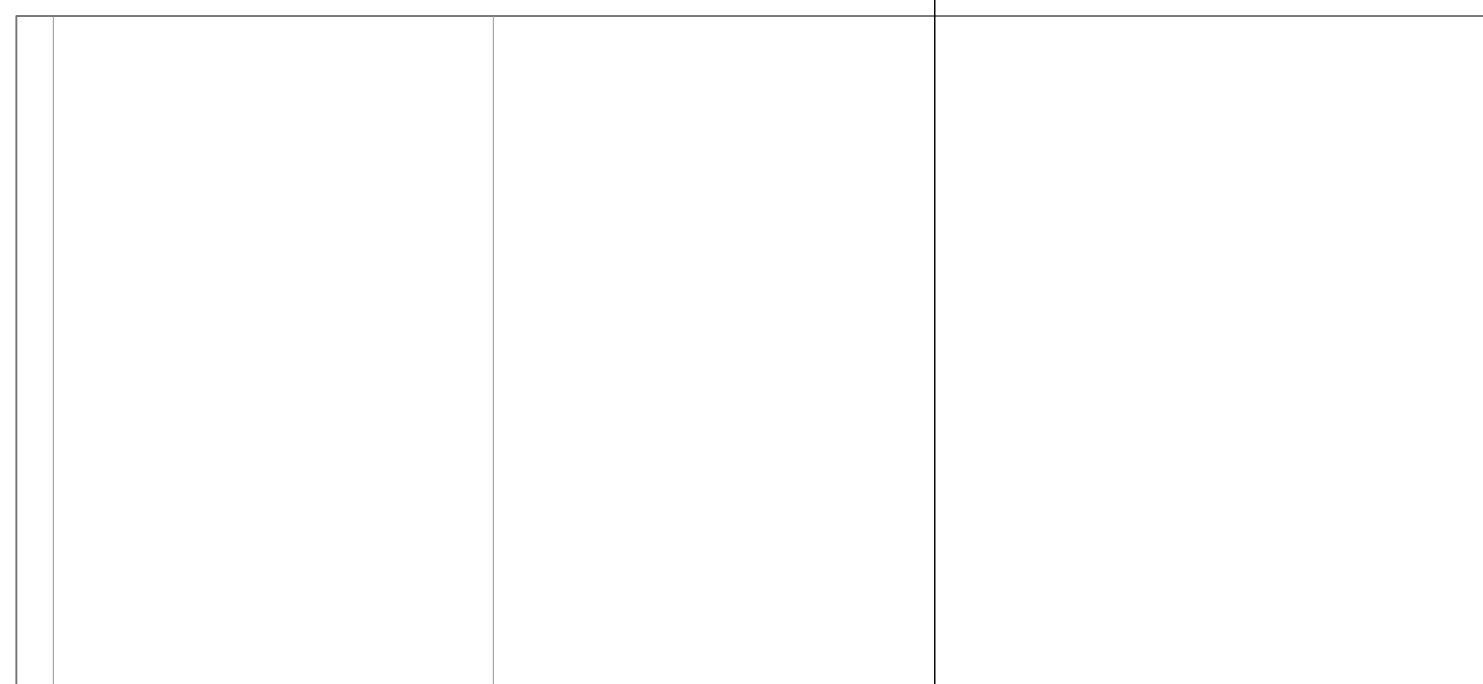

- Kamen
50,43 m2

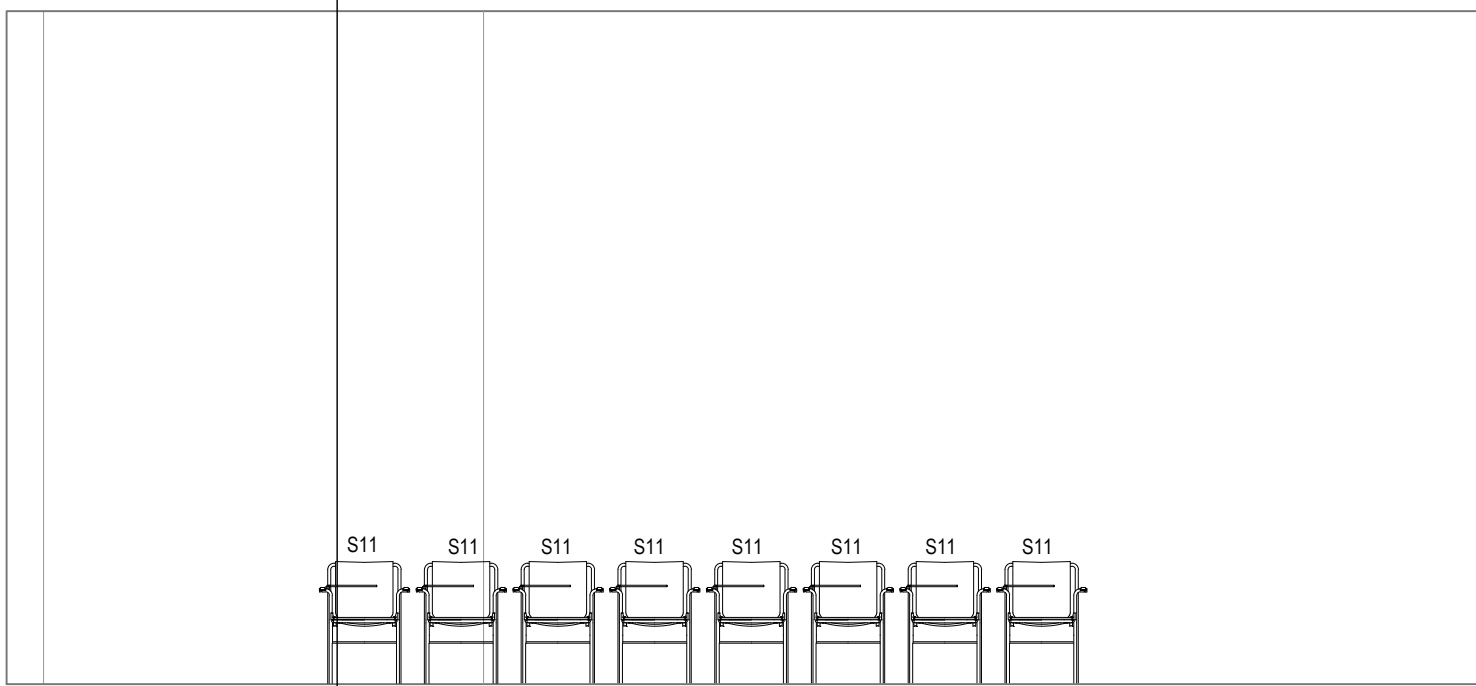
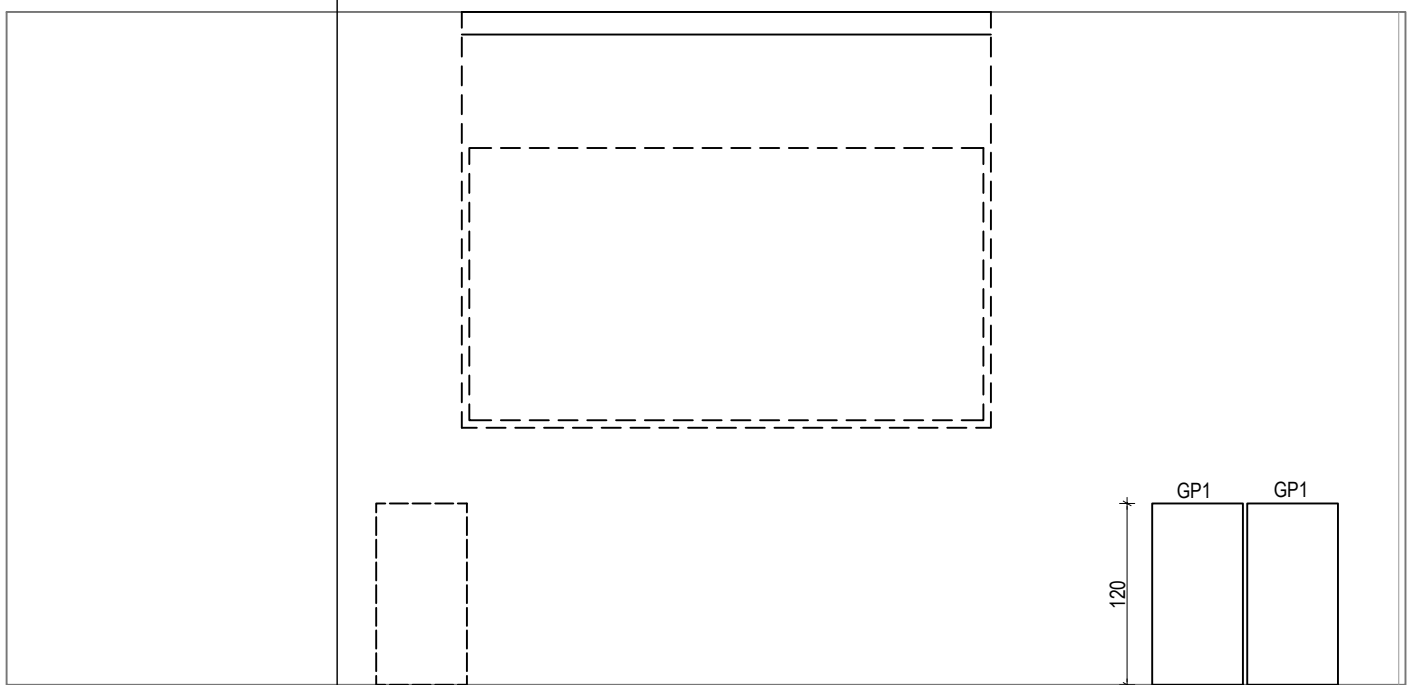
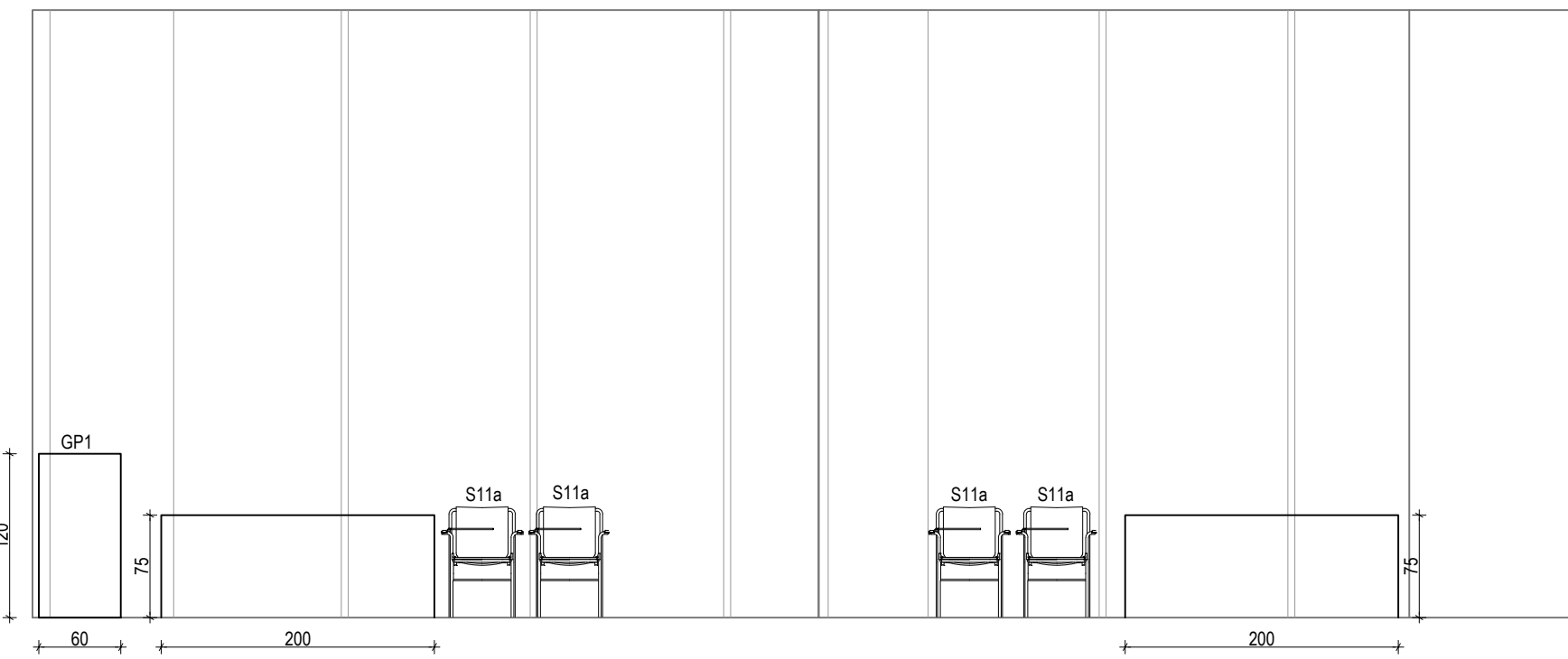
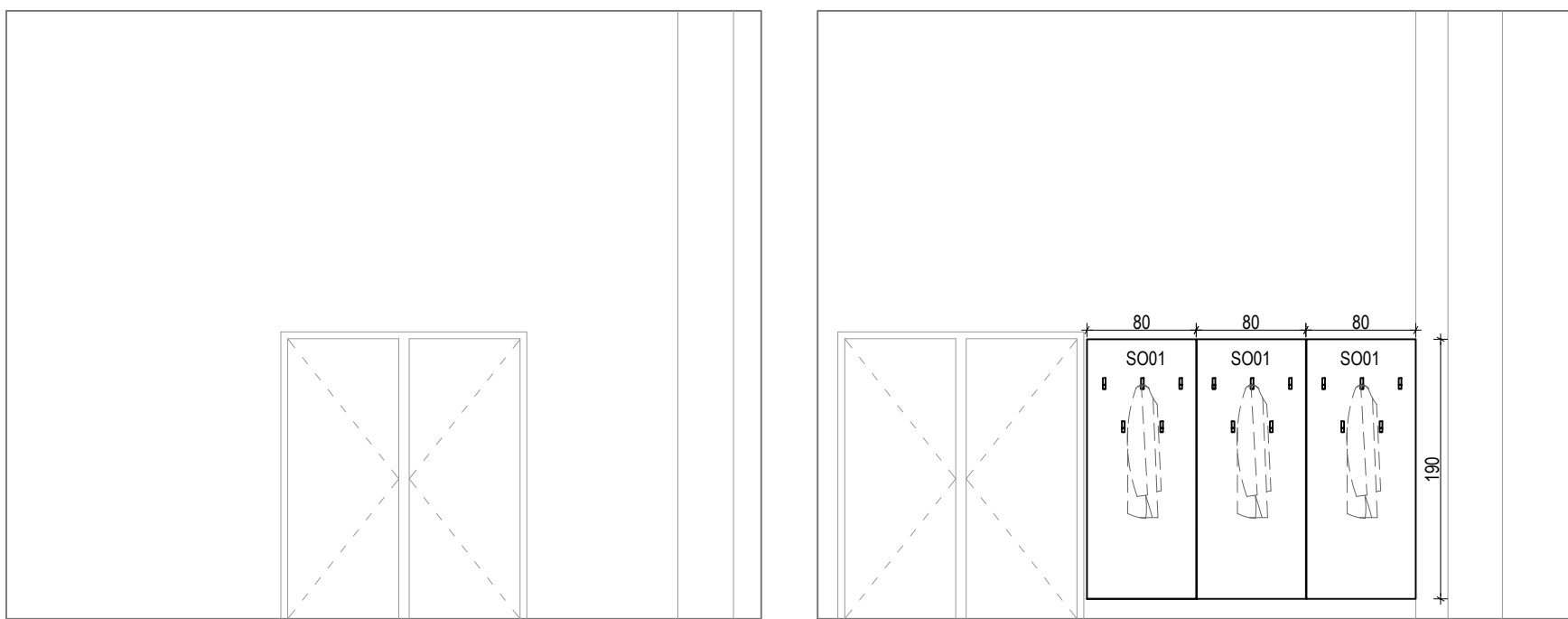
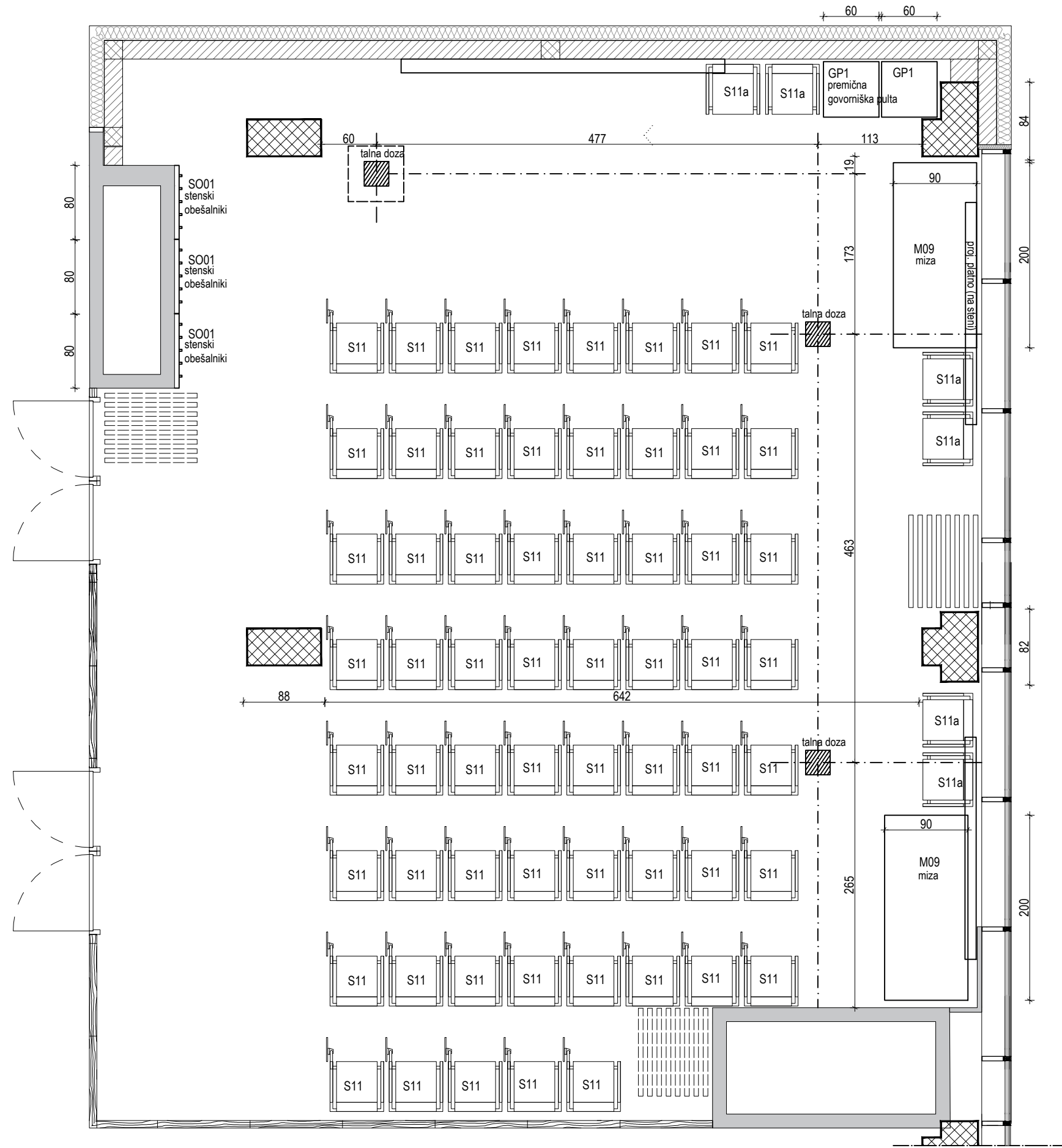

tipsko pohištvo	P27	P28
tehnološka oprema	SK - Predavalnica	
tipski elementi	Kamen	
pohištvo po meri	52,54 m2	